

THE NEIGHBORHOOD

- 162,094 Population
- 113,481 Daytime Ppln
- \$65,771 Median HH income
- 57,000 VPD at Hwy 6 S & Bissonnet St.

Source: Esri Community Analyst 2016

AVAILABLE

Retail 3,000 SF
Pad Available Buildable Up to 1,500 SF

PROVIDENCE PLAZA

9400 Highway 6 S
Houston, TX 77083

LEASING INFORMATION

713.435.2222
www.whitstonereit.com

A NEIGHBORHOOD COMMUNITY CENTER WITH HIGH TRAFFIC & VISIBILITY



FUTURE REDEVELOPMENT

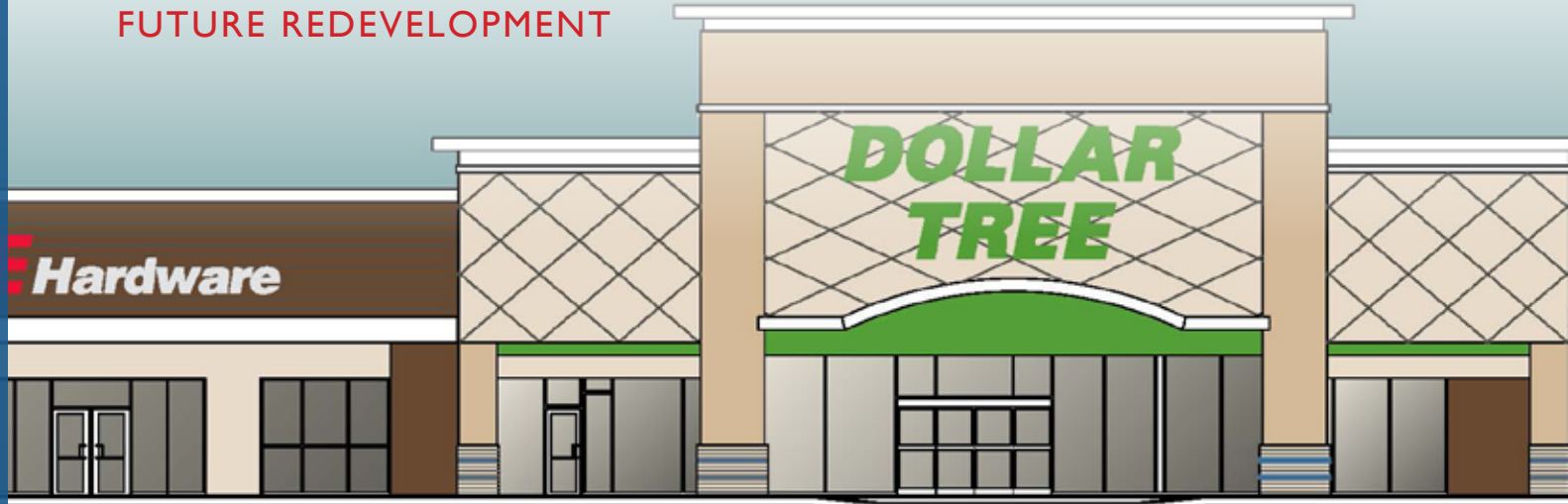

LEASING INFORMATION
713.435.2222
www.whitestonereit.com
PROVIDENCE PLAZA

Source: Esri DEMOGRAPHICS	(2016)	1-Mile	3-Mile	5-Mile
	Population	18,652	162,094	335,127
	Household	5,505	48,314	108,918
	Daytime Population	13,257	113,481	280,133
	Median HH Income	\$65,771	\$59,297	\$55,486



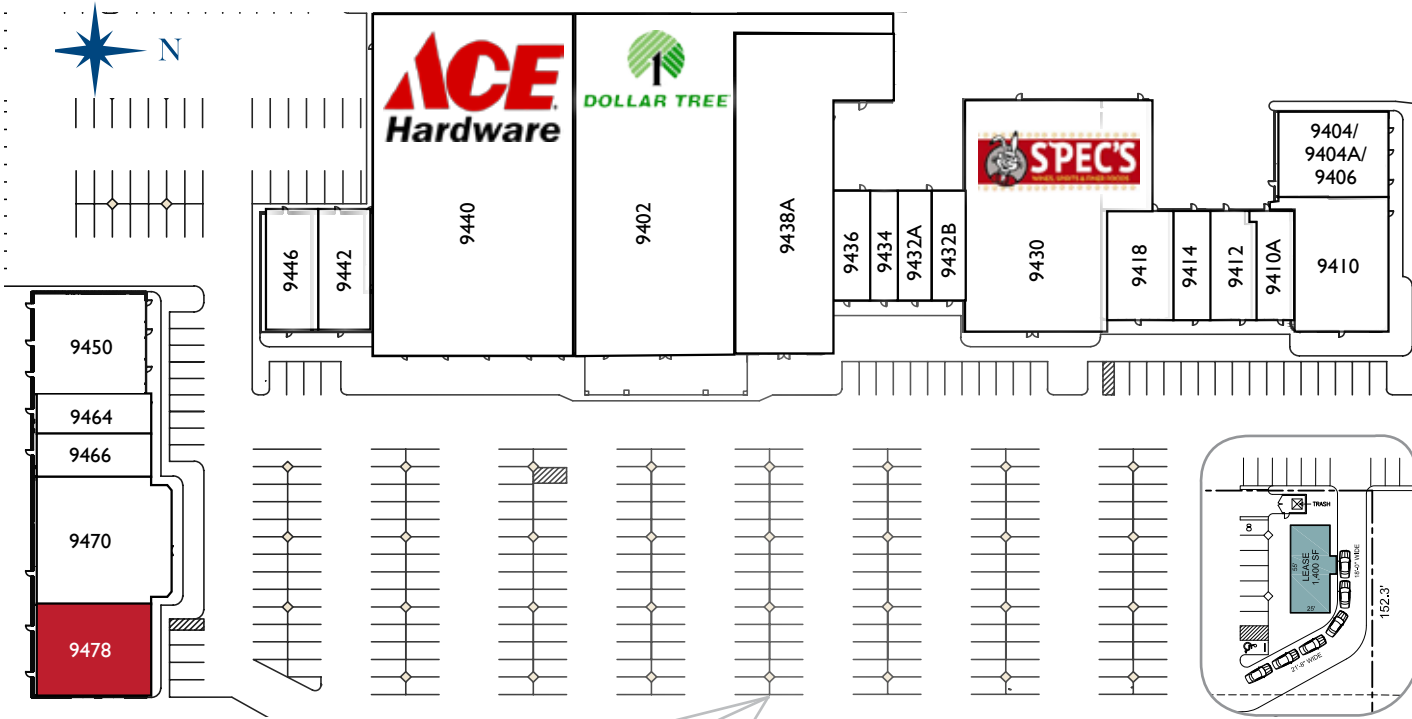

13,000 VPD

BISSONNET STREET

HIGHWAY 6 SOUTH 44,000 VPD

AVAILABLE SIGNAGE:



Space #	Tenant	SF
9402	Dollar Tree	16,307
9404/ 9404A/9406	Vishala Restaurant	2,818
9410	Vishala Grocery Store	3,720
9410A	RJ Salon	1,275
9412	Phalkhi Fashion	1,437
9414	Venkata Entertainments	1,293
9418	ShugremGrooming	2,092
9430	Spec's	10,355
9432A	Miracle Hands Healthcare	960
9432B	YK Nail Salon	1,033
9434	Le Chic Hair Design	1,052
9436	Isabel's Kitchen	1,188
9438A	Beauty Empire	9,724
9440	Ace Hardware	19,929
9442	Taqueria El Rincon	1,950
9446	Plus Cleaners	1,740
9450	Fountain Firearms	3,284
9464	Republic Finance	1,209
9466	Movie One Video	1,507
9470	T&T Fish & Reef	4,904
9478	Available	3,000
Pad Site	Available	1,400

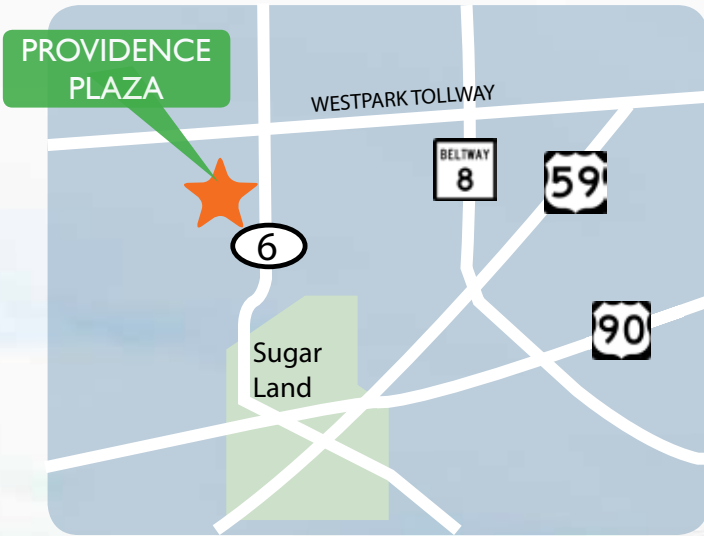

GROCERY & GENERAL RETAIL Dollar Tree • Spec's Wine & Spirit • Vishala Grocery Store • DINING & CAFE Vishala Restaurant • Taqueria El Rincon • Isabel's Kitchen • HEALTH & PERSONAL CARE • YK Nail Salon • Miracle Hands Healthcare • Le Chic Hair Design • RJ Salon • Beauty Empire • Shugrem Grooming • SERVICES Republic Finance • SPECIALTY RETAIL ACE Hardware • Fountain Firearms • T&T Fish and Reef • Palkhi Fashion • Movie One Video



WHITESTONE REIT

Creating Communities in Our Properties™

2600 S. Gessner Road, Suite 500, Houston, Texas 77063 toll free 866.789.7348

LEASING INFORMATION
713.435.2222
www.whitestonereit.com