

BUCKTOWN SIX CORNERS RETAIL SPACE FOR LEASE

1555 N. MILWAUKEE AVE
CHICAGO, IL 60622

Wayne Caplan
Senior Vice President
312.529.5791
wayne.caplan@svn.com

JIMMY JOHN'S

JIMMY JOHN'S
GOURMET SANDWICHES

HOUSE BAKED BREAD * Since 1983 * SANDWICH DELIVERY SPECIALISTS * Since 1983 * CATERING & BOXED LUNCHES

SERIOUS
DELIVERY
489-0100

FREE
SMELLS

Tasty
SUB SHOP

Property Summary

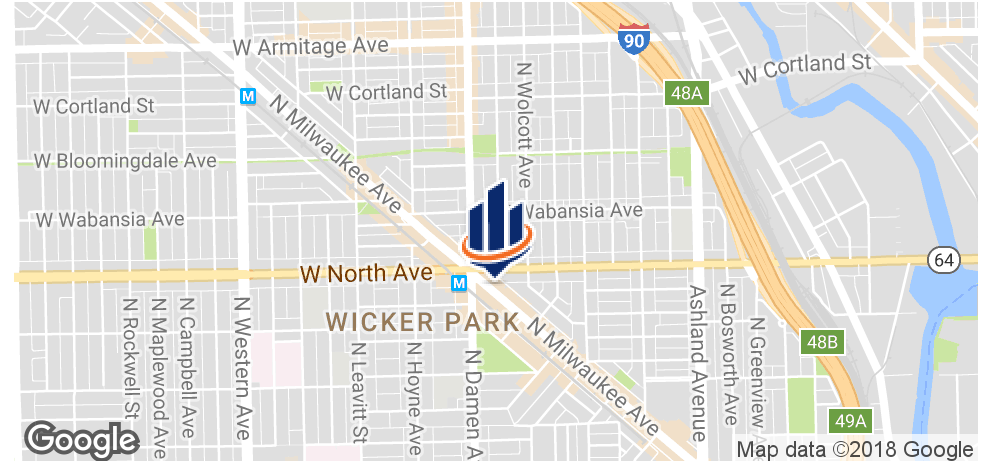

OFFERING SUMMARY

Available SF:	1,790 SF
Lease Rate:	\$45.00 SF/yr (NNN)
Building Size:	1,790 SF
Market:	Chicago
Submarket:	Bucktown/Wicker Park

PROPERTY OVERVIEW

Best retail location in Chicago's pre-eminent Bucktown location. +/- 1790 SF located on Milwaukee Ave steps from the corner of Damen/Milwaukee/North Ave. Currently the long time home of a Jimmy John's sandwich shop, this second generation space with existing bathrooms, HVAC, plumbing and electrical service. Ready to go for your retail/service/food business. Steps to Blue Line Damen "el" stop, and seconds from dozens of high profile retailer/restaurants including Walgreens, Starbucks, Big Star, Le Colombe and dozens of others. Available July 2018.

LOCATION OVERVIEW

The intersection of Milwaukee/Damen/North Ave's in Chicago's Bucktown neighborhood is one of the two or three most sought after neighborhoods in Chicago for retailers and restauranters alike. Incredible density, vehicular and pedestrian traffic counts. Steps to Blue Line Damen el stop and within seconds of just about every national, regional and local shop. Highlights of immediate area tenants include Goddess and Grocer, Starbucks, Big Star, Le Colombe, David's Tea, Walgreens, and dozens of others. High income immediate area demographics of over \$120,000/yr with average area home prices approaching \$675,000.

Area Retailer Map



Regional Map

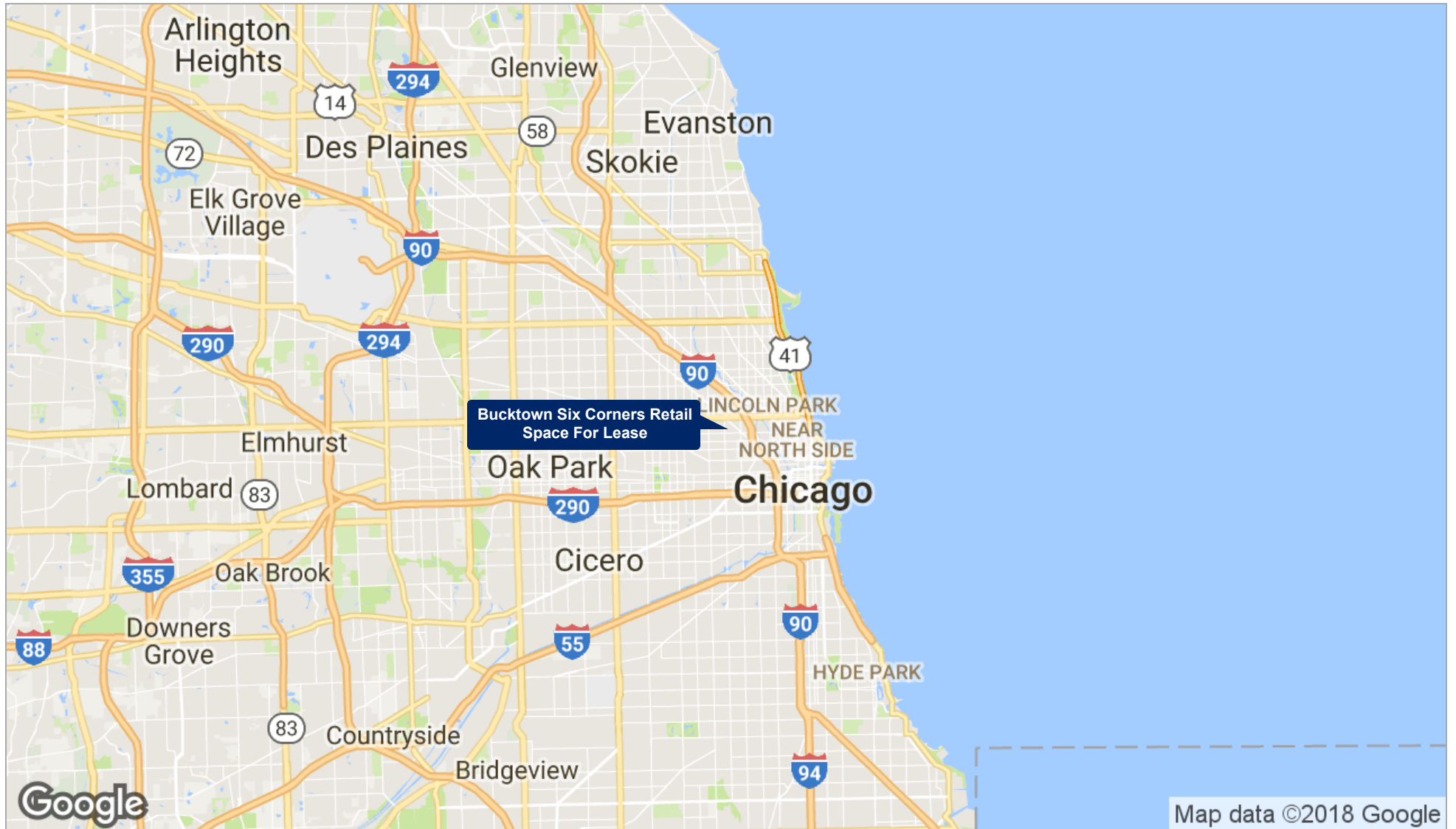

Location Maps

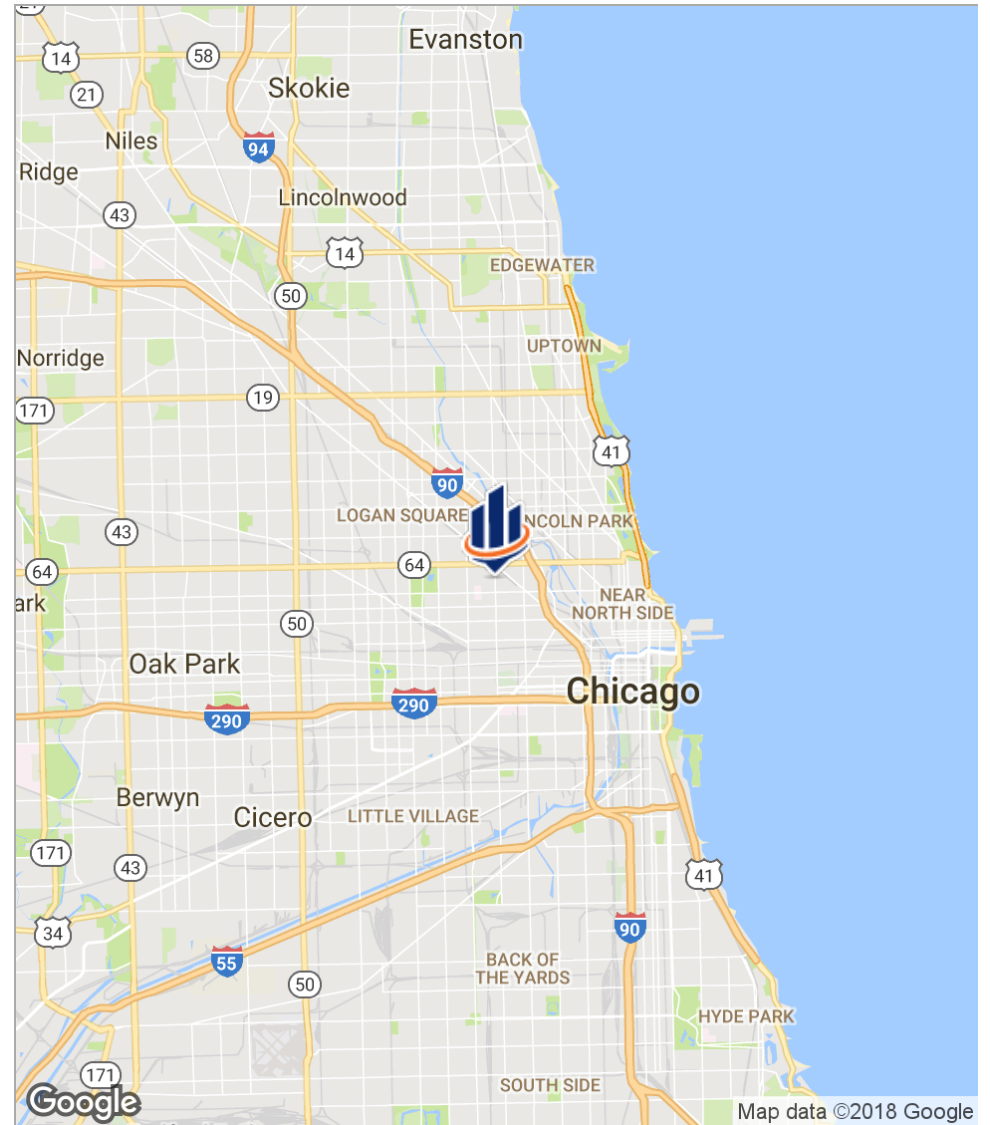
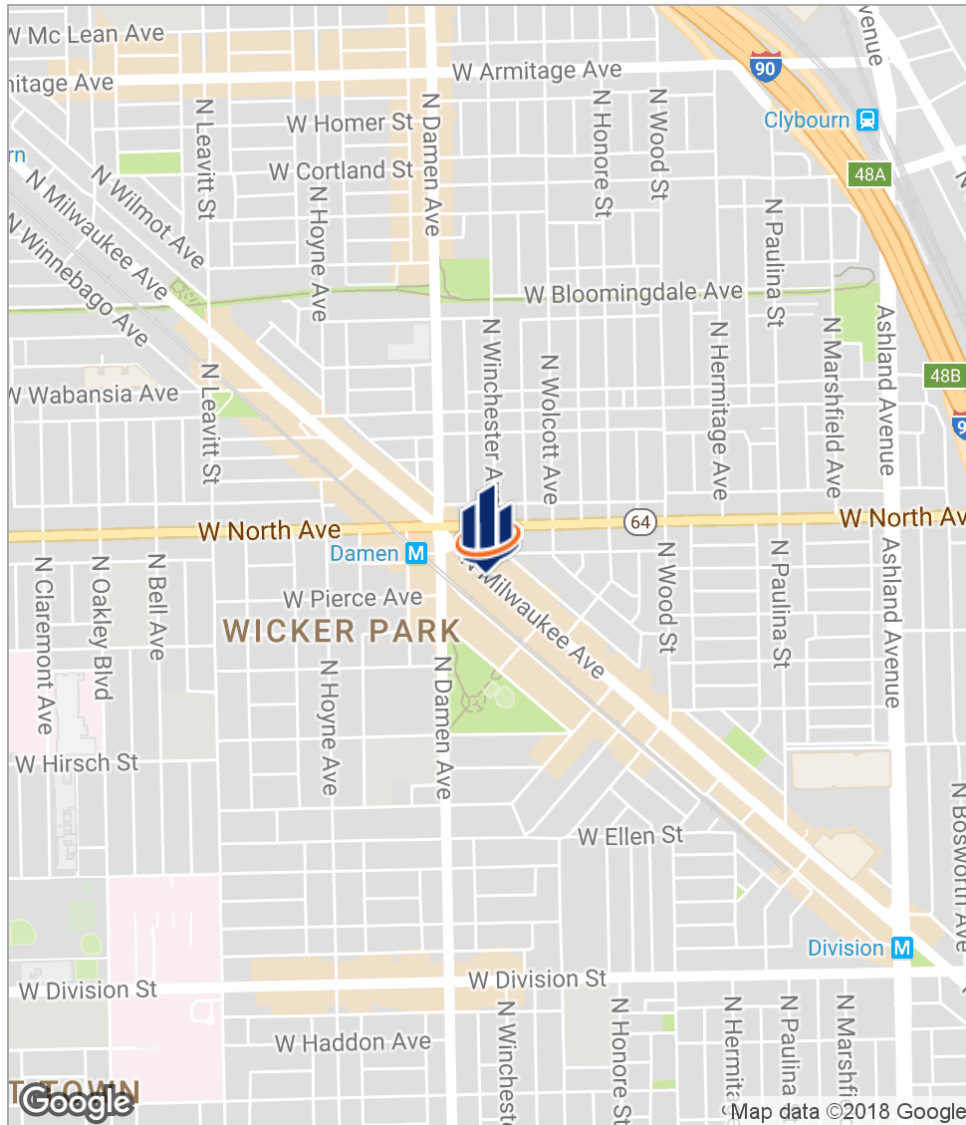

Additional Photos



Full Building View

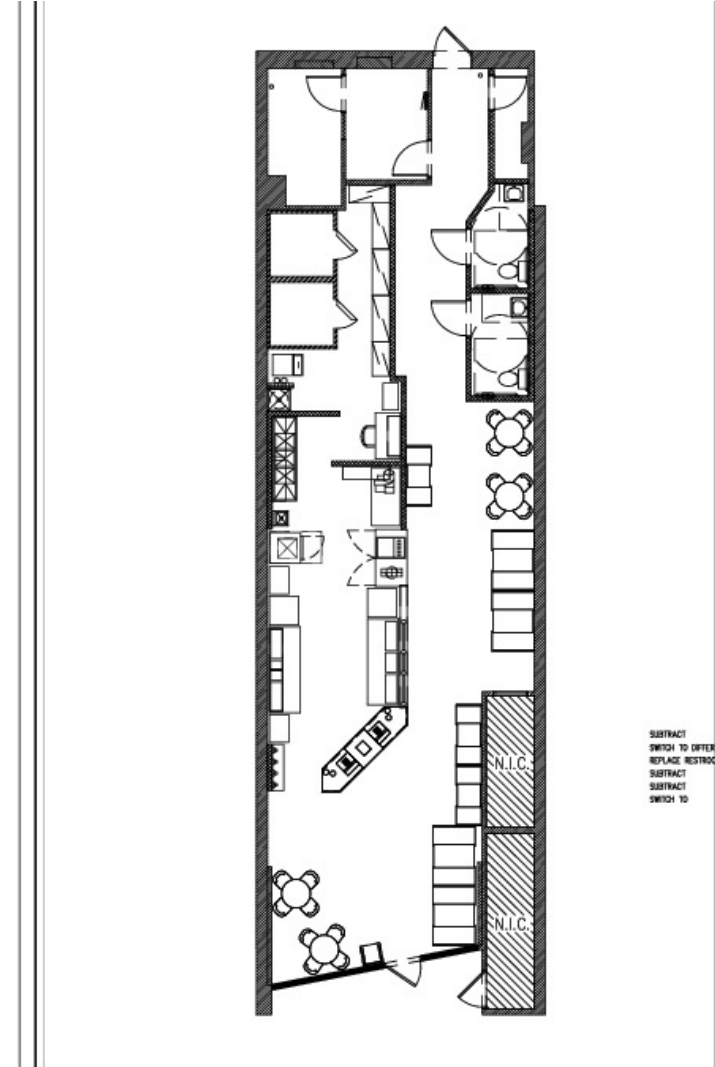

Current Floor Plan

Demographics Map

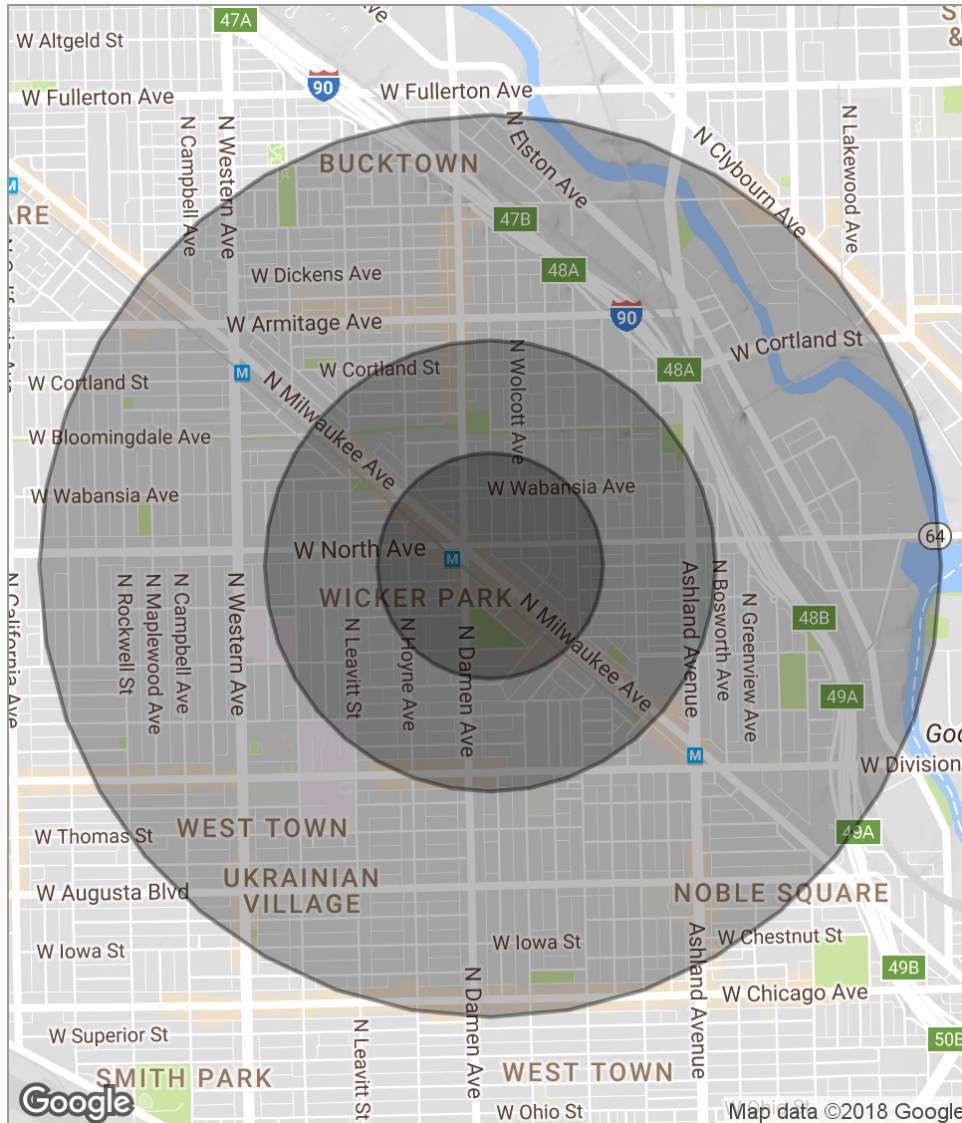

POPULATION	0.25 MILES	0.5 MILES	1 MILE
Total population	4,585	18,495	67,752
Median age	31.7	31.4	30.8
Median age (male)	32.8	32.7	31.6
Median age (Female)	30.4	30.1	30.1
HOUSEHOLDS & INCOME	0.25 MILES	0.5 MILES	1 MILE
Total households	2,189	8,743	31,390
# of persons per HH	2.1	2.1	2.2
Average HH income	\$120,236	\$117,180	\$101,518
Average house value	\$674,089	\$643,495	\$600,740

* Demographic data derived from 2010 US Census

Demographics Report

	0.25 MILES	0.5 MILES	1 MILE
Total population	4,585	18,495	67,752
Median age	31.7	31.4	30.8
Median age (male)	32.8	32.7	31.6
Median age (female)	30.4	30.1	30.1
Total households	2,189	8,743	31,390
Total persons per HH	2.1	2.1	2.2
Average HH income	\$120,236	\$117,180	\$101,518
Average house value	\$674,089	\$643,495	\$600,740

** Demographic data derived from 2010 US Census*

Advisor Bio & Contact

WAYNE CAPLAN

Senior Vice President



940 West Adams Street, Suite 200
Chicago, IL 60607
T 312.529.5791
wayne.caplan@svn.com

PROFESSIONAL BACKGROUND

Wayne Caplan is a Senior Vice President for SVN | Chicago Commercial, specializing in the sale and leasing of retail, investment and development properties. He has participated in commercial property transactions in excess of \$500 million including many high profile transactions in the Chicago area. Wayne recently achieved SVN's prestigious Partner's Circle status for both 2014 & 2016, and was ranked number 23 & 26 respectively, among all SVN advisors nationally in gross commission volume. He also was awarded both a Platinum and Gold Commercial Real Estate Award from the Chicago Association of Realtors for excellence in sales and leasing volume for 2014 and a Platinum award in 2016 for retail sales volume.

Wayne's clients range from small individual investors to large regional and national lending institutions, as well as REITs, life insurance companies, and national mixed-use developers. Additional Awards and Recognitions include being named Rookie of the Year for Inland Real Estate Sales in 2000, a top producer at Sheldon Good & Company for six years, and being among the top ten percent nationally of all 1800+ SVN advisors in gross commission volume for the past nine years. Active in advocacy for the commercial real estate industry, Wayne has served as the Council Chair of Political and Regulatory Affairs for SVN. Wayne is a longtime member of the International Council of Shopping Centers [ICSC]. He also served for many years on the Chicago Association of Realtors [CAR] "Commercial Forum" committee, of which he was the 2006 Committee Chair and has served on the prestigious Board of Directors of the 11,000+ member organization from 2008 - 2013. Wayne has also served on the Commercial Committee for the Illinois Association of Realtors [IAR] and has served as a member of the National Association of Realtors [NAR] board of directors and on both its Commercial and Commercial Legislative & Regulatory Committees. Wayne currently serves on the ICSC Government Relations Committee for Illinois. He is also active in several Chicago neighborhood groups, and serves on the Board of Directors for The Near South Planning Board in Chicago, and Beth Hillel Congregation Bnai Emunah in Wilmette. Wayne is a contributor to charities such as the American Red Cross, The Jewish United Fund and Streetwise. Wayne lives in Glenview, IL with his wife and two sons.

Specialties: Investment Sales, Landlord Representation, Land and Development Consulting

EDUCATION

2003 - MBA - Finance & Real Estate - Northwestern University, Kellogg Graduate School of Management

1988 - BA - Computer Science - New York University

MEMBERSHIPS & AFFILIATIONS

2000 - Present - Member - International Council of Shopping Centers [ICSC]

2002 - Present - Member - National Association of Realtors [NAR]

2002 - Present - Member - Illinois Association of Realtors [IAR]

2002 - Present - Member - Chicago Association of Realtors [CAR]

1986 - Present - Member - Psi Upsilon Fraternity - Delta Chapter - New York University

Member - Beth Hillel Congregation Bnai Emunah - Wilmette, IL

Disclaimer

The material contained in this Offering Brochure is furnished solely for the purpose of considering a lease of a portion of the property within and is not to be used for any other purpose. This information should not, under any circumstances, be photocopied or disclosed to any third party without the written consent of the SVN® Advisor or Property Owner ["Owner"], or used for any purpose whatsoever other than to evaluate the possible lease of the Property.

The only party authorized to represent the Owner in connection with the lease of the Property is the SVN Advisor listed in this proposal, and no other person is authorized by the Owner to provide any information or to make any representations other than contained in this Lease Offering Brochure. If the person receiving these materials does not choose to pursue a lease of the Property, this Lease Offering Brochure must be returned to the SVN Advisor.

Neither the SVN Advisor nor the Owner make any representation or warranty, express or implied, as to the accuracy or completeness of the information contained herein, and nothing contained herein is or shall be relied upon as a promise or representation as to the future representation of the Property. This Lease Offering Brochure may include certain statements and estimates by SVN with respect to the Property. These Assumptions may or may not be proven to be correct, and there can be no assurance that such estimates will be achieved. Further, the SVN Advisor and the Owner disclaim any and all liability for representations or warranties, expressed or implied, contained in or omitted from this Lease Offering Brochure, or any other written or oral communication transmitted or made available to the recipient. The recipient shall be entitled to rely solely on those representations and warranties that may be made to it in any final, fully executed and delivered Real Estate Lease Agreement between it and Owner.

The information contained herein is subject to change without notice and the recipient of these materials shall not look to Owner or the SVN Advisor, nor any of their officers, employees, representatives, independent contractors or affiliates, for the accuracy or completeness thereof. Recipients of this Lease Offering Brochure are advised and encouraged to conduct their own comprehensive review and analysis of the Property.

This Lease Offering Brochure is a solicitation of interest only and is not an offer to lease the Property. The Owner expressly reserves the right, at its sole discretion, to reject any or all expressions of interest to lease the Property and expressly reserves the right, at its sole discretion, to terminate negotiations with any entity, for any reason, at any time with or without notice. The Owner shall have no legal commitment or obligation to any entity reviewing the Lease Offering Brochure or making an offer to lease the Property unless and until the Owner executes and delivers a signed Real Estate Lease Agreement on terms acceptable to Owner, in Owner's sole discretion. By submitting an offer to lease, a prospective lessee will be deemed to have acknowledged the foregoing and agreed to release the Owner and the SVN Advisor from any liability with respect thereto.

To the extent Owner or any agent of Owner corresponds with any prospective lessee, any prospective lessee should not rely on any such correspondence or statements as binding Owner. Only a fully executed Real Estate Lease Agreement shall bind the property and each prospective purchaser proceeds at its own risk.