

217

SEVENTH AVENUE

BETWEEN WEST 22ND & 23RD STREET | NEW YORK CITY



Jack Resnick & Sons
Owners & Builders Since 1928

Member
REBNY
REAL ESTATE BOARD OF NEW YORK

EXCLUSIVE LEASING AGENT:



**CUSHMAN &
WAKEFIELD**

217

SEVENTH AVENUE

BETWEEN WEST 22ND & 23RD STREET | NEW YORK CITY

GROUND FLOOR

3,780 sf

FRONTAGE

29 Feet

on Seventh Avenue

CEILING HEIGHTS

15 Feet

KEY COMMENTS

- Heavy foot traffic from dense residential and office population
- Prime branding & visibility in the heart of Chelsea at 23rd Street & 7th Avenue
- Situated below a residential condo, amidst specialty shopping, dining & hotels
- Steps from transportation including:
23rd Street Subway

NEIGHBORS

TD Bank • Janovic • Starbucks • Whole Foods • Dunkin
Donuts • Chase Bank • Spa Belles



NEARBY TRANSPORTATION

WEEKDAY
SUBWAY RIDERSHIP

15,451

1 23rd Street & Seventh Avenue

30,652

F M 23rd Street & Sixth Avenue

25,731

C E 23rd Street & Eighth Avenue

217

SEVENTH AVENUE

BETWEEN WEST 22ND & 23RD STREET | NEW YORK CITY

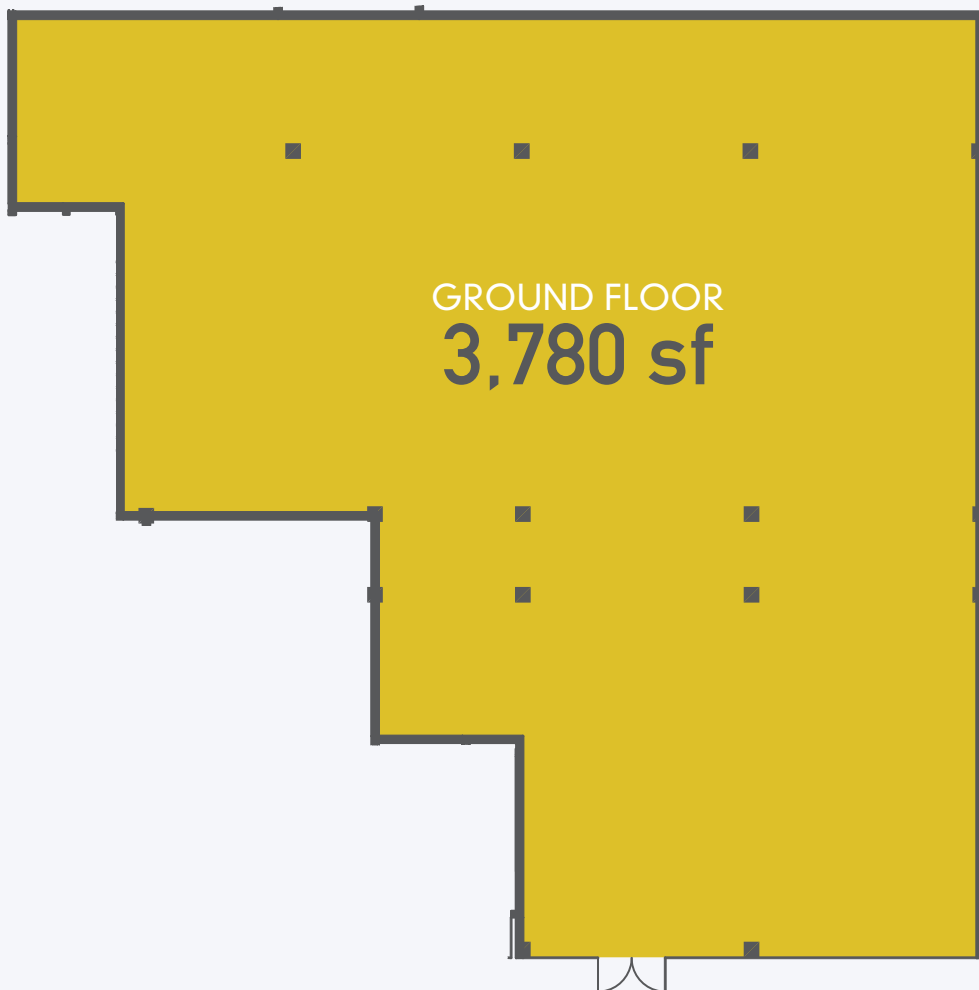

SEVENTH AVENUE

SEVENTH AVENUE

217

SEVENTH AVENUE

BETWEEN WEST 22ND & 23RD STREET | NEW YORK CITY

For more information, contact Exclusive Lease Agent:

JOANNE PODELL

212 841 5972

JOANNE.PODELL@CUSHWAKE.COM

MATTHEW BALL

212 713 6865

MATTHEW.BALL@CUSHWAKE.COM



Jack Resnick & Sons
Owners & Builders Since 1928

Member
REBNY
REAL ESTATE BOARD OF NEW YORK

EXCLUSIVE LEASING AGENT:



A commission computed and earned in accordance with the rates and conditions of our agency agreement with our principal, when received from our principal, will be paid to the cooperating broker who consummates a lease which is unconditionally executed and delivered by and between lessor and lessee (a copy of the rates and conditions referred to above is available upon request). The depiction in the attached images of any person, entity, sign, logo or property (other than Cushman & Wakefield's client and the property offered by Cushman & Wakefield) is incidental only, and is not intended to connote any affiliation, connection, association, sponsorship or approval by or between that which is incidentally depicted by Cushman & Wakefield or its client.