

PRIME PEARL DISTRICT BUILDING(S) FOR LEASE/REDEVELOPMENT



555/569 S. PEORIA, TULSA, OK

SIZES

- 4,415 SF 8-bay multi-warehouse/showroom available
- Up to 7,515 SF in 3 buildings can be combined
- 35,100 SF land (0.80 AC)

FEATURES

- Former Automotive Facility
- Pearl District location next to 6th Street
- BTS/Retrofit potential for qualified redevelopment
- Flexible Commercial Heavy (CH) zoning
- Large concreted lot behind building (Quaker Ave)
- 16' clear, compressed air, water drains
- 10'x10', 10'x12' OH Doors
- Large marquee signage to Peoria
- Across from City of Tulsa's Centennial Park
- Close proximity to Blue Dome, East Village and The Brady District
- 41,000 CBD workforce population
- Emerging retail/restaurant district including Phoenix Cafe, Papa Ganouj and One Architecture
- 1/2 mile east of CBD with easy 6th street access
- 1 mile access to I-244, Hwy 51 (BA Expressway) and IDL



Tulsa CBD/Pearl District Area Map

The information contained herein is believed to be accurate but is not guaranteed as to accuracy and may change or be updated without notice.

Contact: Monty Berry, CCIM

Office (918) 280-9900 | **Cell** (918) 695-4162 | **Fax** (918) 280-9902
E-mail Monty@EquitasRealty.com

Aerial



CBD Views/Centennial Park

Floor Plan

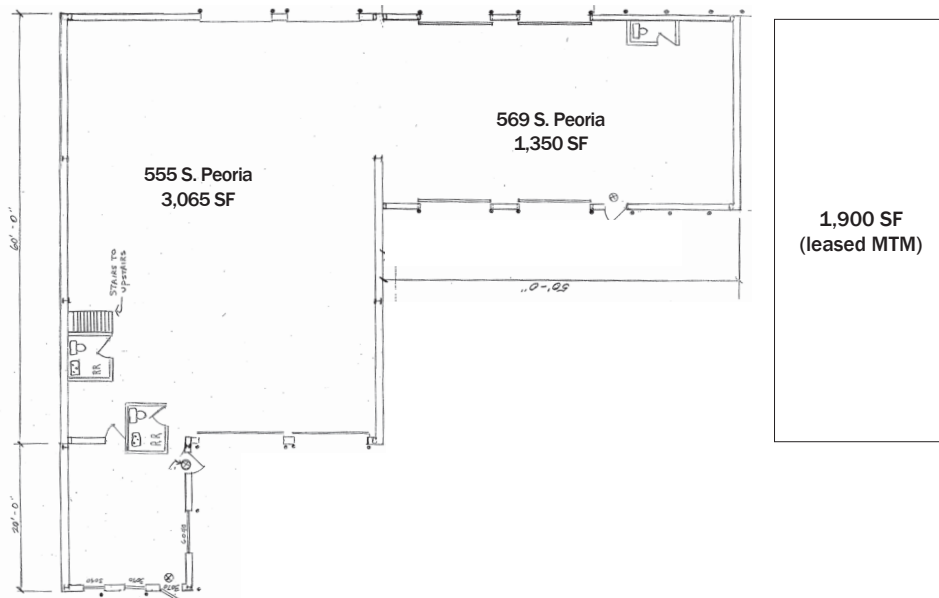

S. PEORIA

E. 6th STREET



Warehouse with OH Doors



555 Peoria Building



569 Peoria Building



Interior Reception/Counter



Exterior Back of Building