



Contact: Steve Royal
561-996-8080 ext 71
steve.royal@theroyalcompanies.com



Okeechobee Plaza

Okeechobee, FL



Area Facts:

- * 2009 Population of 25,933 within 5 miles
- * Estimated Traffic Count of 22,500
- * 2009 Average Household Income \$50,911



** Stable Underserved Community **

- * Lighted Intersection
- * Excellent Exposure off of US 441
- * Centrally Located on Northern tip of Lake Okeechobee

Area Retailers:



Information contained herein deemed reliable but not warranted

802 N.W. 1st Street South Bay, Florida Phone: 561-996-8080 Fax: 561-996-8327
www.theroyalcompanies.com

Okeechobee Plaza

Okeechobee, FL



1A. For Lease - 2,000 sf
1B. Big Lake Kidney
2. Winn Dixie
3. Hungry Howies
4. Thompson Jewelry
5. For Lease - 1,200 sf
6. For Lease - 1,500 sf

7. Stafford's Hair Salon
8. For Lease - 1,200 sf
9 & 10. H&R Block
11. Beltone Hearing
12-15. Goodwill
16 & 17 Beall's Outlet
Outparcel- For Lease- 3,248 sf

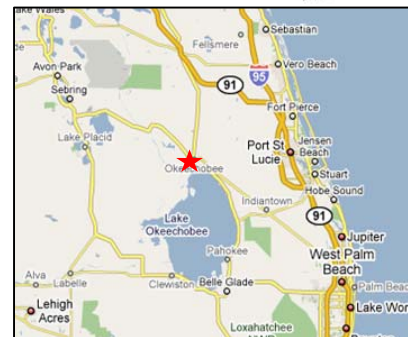



Okeechobee Plaza

Unit 1A Approximately 2,000 sq ft +/-



Contact: Steve Royal
561-996-8080 x 71

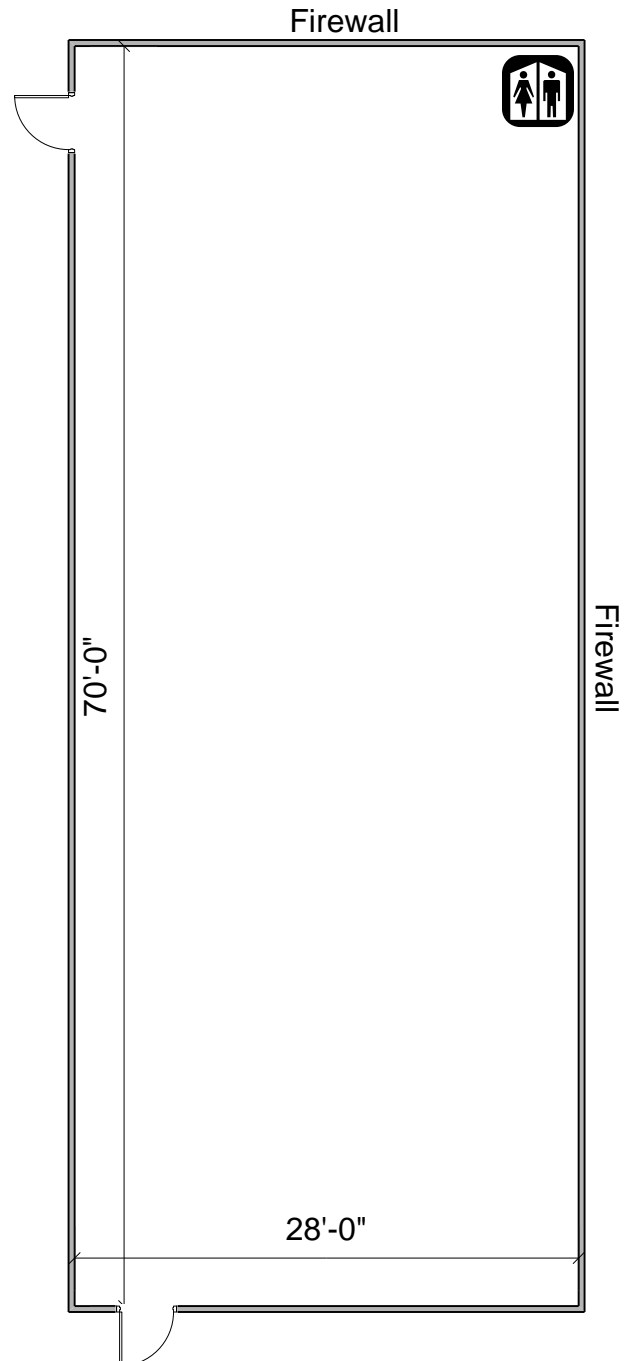

www.theroyalcompanies.com

The information above has been obtained from sources believed reliable. While we do not doubt its accuracy we have not verified it and make no guarantee, warranty or representation about it. It is your responsibility to independently confirm its accuracy and completeness. Any projections, opinions, assumptions, or estimates used are for example only and do not represent the current or future performance of the property. The value of this transaction to you depends on tax and other factors which should be evaluated by your tax, financial, and legal advisors. You and your advisors should conduct a careful, independent investigation of the property to determine to your satisfaction the suitability of the property for your needs.



The information above has been obtained from sources believed reliable. While we do not doubt its accuracy we have not verified it and make no guarantee, warranty or representation about it. It is your responsibility to independently confirm its accuracy and completeness. Any projections, opinions, assumptions, or estimates used are for example only and do not represent the current or future performance of the property. The value of this transaction to you depends on tax and other factors which should be evaluated by your tax, financial, and legal advisors. You and your advisors should conduct a careful, independent investigation of the property to determine to your satisfaction the suitability of the property for your needs.



Okeechobee Plaza

Unit 6 Approximately 1,500 sq ft +/-

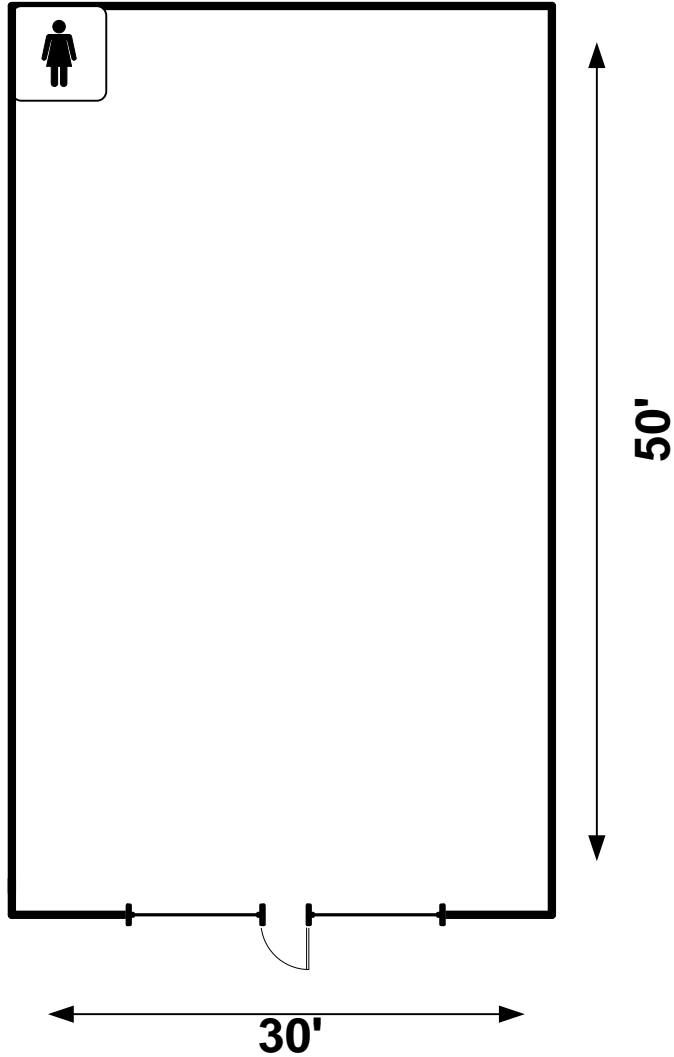

Contact: Steve Royal
561-996-8080 x 71

www.theroyalcompanies.com

The information above has been obtained from sources believed reliable. While we do not doubt its accuracy we have not verified it and make no guarantee, warranty or representation about it. It is your responsibility to independently confirm its accuracy and completeness. Any projections, opinions, assumptions, or estimates used are for example only and do not represent the current or future performance of the property. The value of this transaction to you depends on tax and other factors which should be evaluated by your tax, financial, and legal advisors. You and your advisors should conduct a careful, independent investigation of the property to determine to your satisfaction the suitability of the property for your needs.



Okeechobee Plaza

Unit 8

Approximately 1,200 sf +/-



Contact: Steve Royal
561.996.8080 x 71

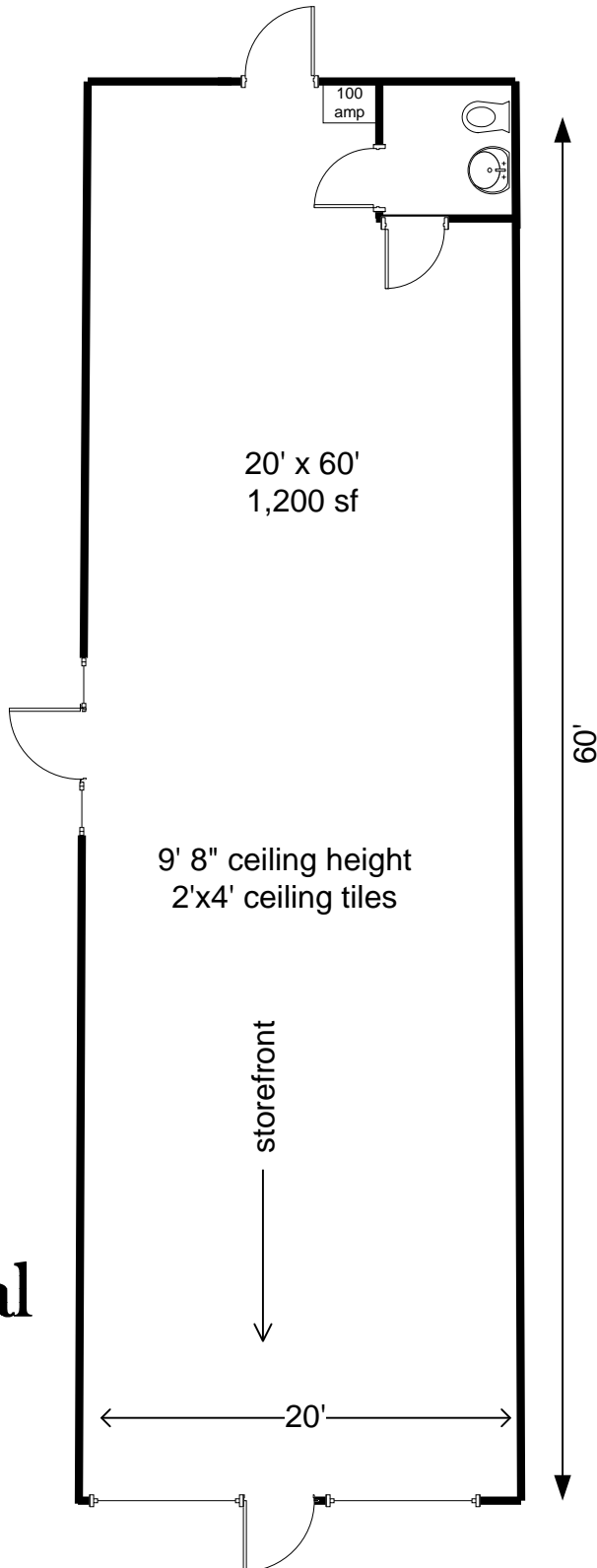

www.theroyalcompanies.com

The information above has been obtained from sources believed reliable. While we do not doubt its accuracy we have not verified it and make no guarantee, warranty or representation about it. It is your responsibility to independently confirm its accuracy and completeness. Any projections, opinions, assumptions, or estimates used are for example only and do not represent the current or future performance of the property. The value of this transaction to you depends on tax and other factors which should be evaluated by your tax, financial, and legal advisors. You and your advisors should conduct a careful, independent investigation of the property to determine to your satisfaction the suitability of the property for your needs.