

Property Snapshot

- Located in the East Towne Mall shopping corridor directly in front of Target & Michael's.
- Great mixture of tenants in the strip center including Sprint, America's Best, Barbershop, & Jenny Craig.
- Well acquainted suites with move-in ready finishes.
- Located just off of East Washington Avenue (40,000 vehicles per day) and surrounded by numerous retailers. Great destination retail setting at a phenomenal value!

Available Spaces

4237—Suite J
1,189 SF
Former Medical Suite

PLEASE CONTACT

Chris Richards

Senior Commercial Real Estate Associate

608.443.1039 Direct

crichards@oakbrookcorp.com

Property Profile

Building Size:	27,495 SF
Lot Size:	2.78 Acres
Parking:	5.11 stalls per 1,000 SF
Lease Term	1 year minimum
Lease Rate	\$14.00 psf
Expenses	\$4.89 estimated NNN charges
Available	Immediately



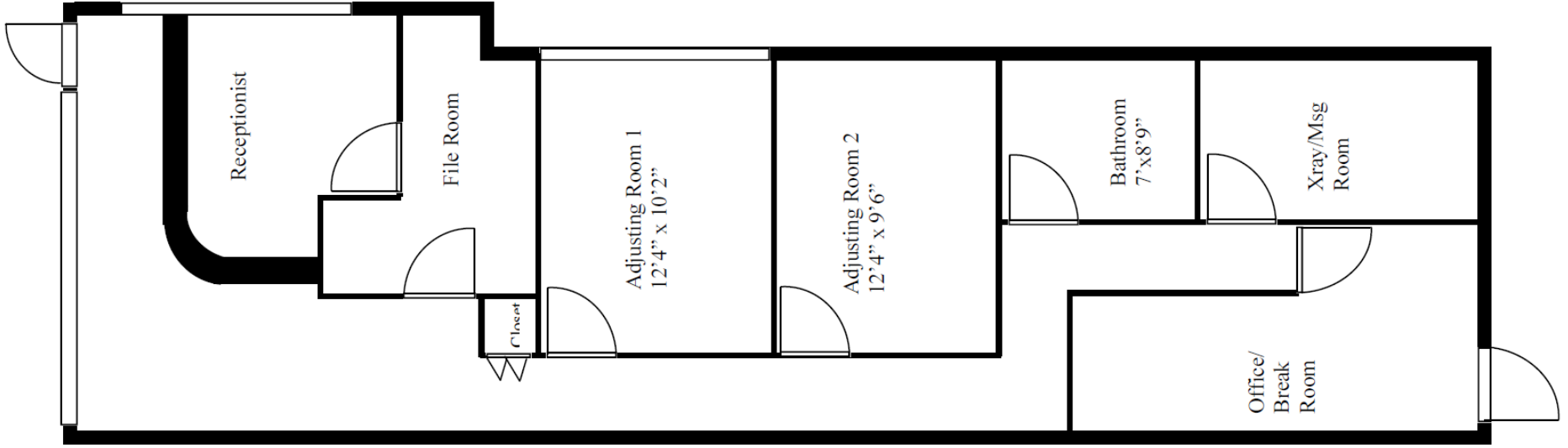

Demographics

Population	1 Mile	3 Mile	5 Mile
2017 Total Population:	7,933	55,076	116,473
2022 Population:	8,375	58,020	122,838
Pop Growth 2017-2022:	5.57%	5.35%	5.46%
Average Age:	34.40	37.60	37.90
Households			
2017 Total Households:	3,337	24,613	52,817
HH Growth 2017-2022:	5.51%	5.28%	5.43%
Median Household Inc:	\$56,573	\$56,534	\$58,824
Avg Household Size:	2.40	2.20	2.20
2017 Avg HH Vehicles:	2.00	2.00	2.00
Housing			
Median Home Value:	\$181,812	\$175,345	\$191,847
Median Year Built:	1991	1971	1971



Aerial



DISCLOSURE TO NON-RESIDENTIAL CUSTOMERS

1 Prior to negotiating on your behalf the brokerage firm, or an agent associated with the firm, must provide you the
2 following disclosure statement:

3 **DISCLOSURE TO CUSTOMERS**

4 You are a customer of the brokerage firm (hereinafter Firm). The Firm is either an agent
5 broker or a salesperson acting on behalf of the Firm may provide brokerage services to you. Whenever the Firm is
6 providing brokerage services to you, the Firm and its brokers and salespersons (hereinafter Agents) owe you, the
7 customer, the following duties:

- 8 (a) The duty to provide brokerage services to you fairly and honestly.
- 9 (b) The duty to exercise reasonable skill and care in providing brokerage services to you.
- 10 (c) The duty to provide you with accurate information about market conditions within a reasonable time if you request
11 it, unless disclosure of the information is prohibited by law.
- 12 (d) The duty to disclose to you in writing certain Material Adverse Facts about a property, unless disclosure of the
13 information is prohibited by law (see lines 42-51).
- 14 (e) The duty to protect your confidentiality. Unless the law requires it, the Firm and its Agents will not disclose your
15 confidential information or the confidential information of other parties (see lines 23-41).
- 16 (f) The duty to safeguard trust funds and other property held by the Firm or its Agents.
- 17 (g) The duty, when negotiating, to present contract proposals in an objective and unbiased manner and disclose the
18 advantages and disadvantages of the proposals.

19 Please review this information carefully. An Agent of the Firm can answer your questions about brokerage services,
20 but if you need legal advice, tax advice, or a professional home inspection, contact an attorney, tax advisor, or home
21 inspector. This disclosure is required by section 452.135 of the Wisconsin statutes and is for information only. It is a
22 plain-language summary of the duties owed to a customer under section 452.133(1) of the Wisconsin statutes.

23 **CONFIDENTIALITY NOTICE TO CUSTOMERS**

24 The Firm and its Agents will keep confidential any information given to the
25 Firm or its Agents in confidence, or any information obtained by the Firm and its Agents that a reasonable person
26 would want to be kept confidential, unless the information must be disclosed by law or you authorize the Firm to
27 disclose particular information. The Firm and its Agents shall continue to keep the information confidential after the
28 Firm is no longer providing brokerage services to you.

29 The following information is required to be disclosed by law:

- 30 1. Material Adverse Facts, as defined in Wis. Stat. § 452.01(5g) (see lines 42-51).
- 31 2. Any facts known by the Firm or its Agents that contradict any information included in a written inspection
32 report on the property or real estate that is the subject of the transaction.

33 To ensure that the Firm and its Agents are aware of what specific information you consider confidential, you may
34 list that information below (see lines 35-41) or provide that information to the Firm or its Agents by other means. At a
35 later time, you may also provide the Firm or its Agents with other information you consider to be confidential.

35 **CONFIDENTIAL INFORMATION:**

36 _____
37 _____
38 **NON-CONFIDENTIAL INFORMATION** (the following information may be disclosed by the Firm and its Agents): _____
39 _____
40 _____

41 _____
42 **DEFINITION OF MATERIAL ADVERSE FACTS**

(Insert information you authorize to be disclosed, such as financial qualification information.)

43 A "Material Adverse Fact" is defined in Wis. Stat. § 452.01(5g) as an Adverse Fact that a party indicates is of such
44 significance, or that is generally recognized by a competent licensee as being of such significance to a reasonable
45 party, that it affects or would affect the party's decision to enter into a contract or agreement concerning a transaction
46 or affects or would affect the party's decision about the terms of such a contract or agreement.

47 An "Adverse Fact" is defined in Wis. Stat. § 452.01(1e) as a condition or occurrence that a competent licensee
48 generally recognizes will significantly and adversely affect the value of the property, significantly reduce the structural
49 integrity of improvements to real estate, or present a significant health risk to occupants of the property; or information
50 that indicates that a party to a transaction is not able to or does not intend to meet his or her obligations under a
51 contract or agreement made concerning the transaction.

52 **NOTICE ABOUT SEX OFFENDER REGISTRY**

53 You may obtain information about the sex offender registry and persons
54 registered with the registry by contacting the Wisconsin Department of Corrections on the Internet at
55 <http://www.doc.wi.gov> or by telephone at 608-240-5830.

No representation is made as to the legal validity of any provision or the adequacy of any provision in any specific transaction.
Copyright © 2016 by Wisconsin REALTORS® Association. Drafted by Attorney Debra Peterson Conrad