

Hampden Heights Business Park
3213 W Hampden Ave, Englewood, CO 80110

2,400 SF

Warehouse with Loading Dock
280 SF Office Space
\$12.00 Modified Gross

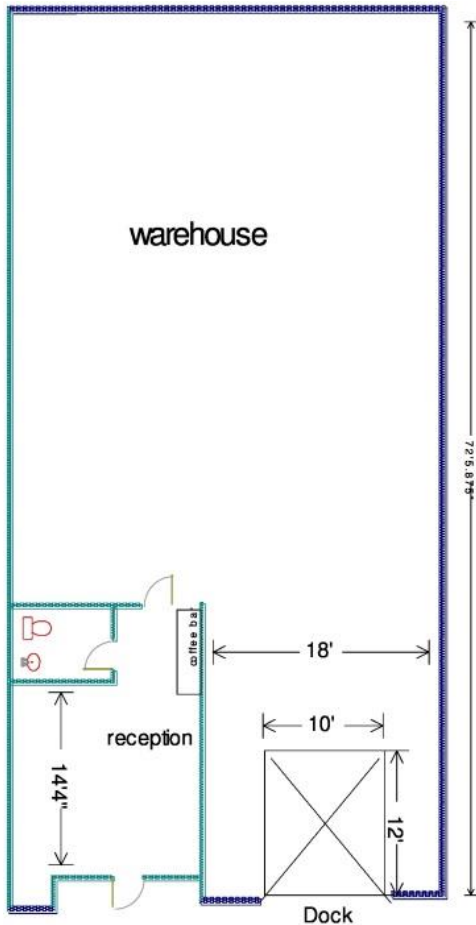

- Floor-to-ceiling glass in reception area
- Skylights
- Private restroom
- Coffee bar with sink, and cabinets
- Dock-Hi with 10' x 12' overhead door
- Ample parking, good access for truck loading
- 100 amps/3 phase
- Easy access to Hwy 285, Santa Fe Dr., I-25, and C-470
- Easy access to public transportation

