

FOR LEASE - 36,618 SF AVAILABLE

# 1301 EAST ARAPAHO ROAD

RICHARDSON, TEXAS 75081



## BUILDING HIGHLIGHTS

Suite	Available SF	Floor
104	17,408	1 <sup>st</sup>
201	3,360	2 <sup>nd</sup>
202	3,313	2 <sup>nd</sup>
204	4,475	2 <sup>nd</sup>
206	8,062	2 <sup>nd</sup>

- Flexible demise options
- Office and warehouse available
- Dock high and drive-in loading available
- Contemporary building appeal
- Great ingress and egress into the property
- Abundant parking - 4/1,000 ratio
- After hours card access and on-site security

## LOCATION HIGHLIGHTS

- Located in the heart of the Richardson submarket
- Located on major road with high traffic signage opportunities
- Close proximity to I-75

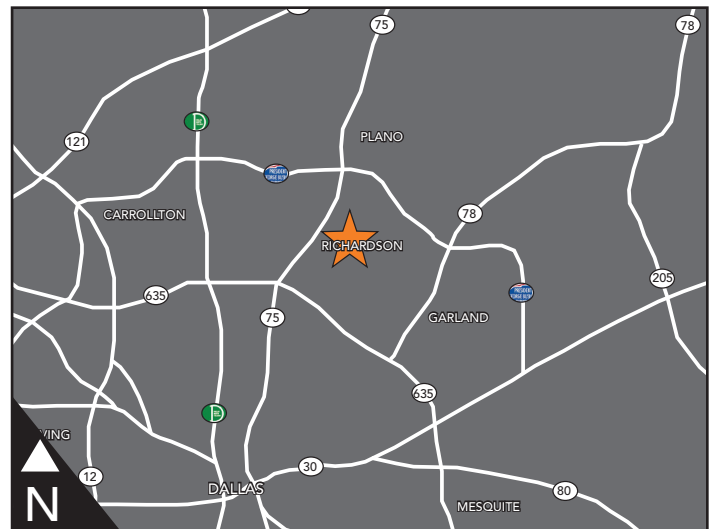

## FOR INFORMATION CONTACT

Joe Whitmer  
214.446.4556  
joe.whitmer@transwestern.com

Emily Rankin  
214.446.4571  
emily.rankin@transwestern.com

**T** **TRANSWESTERN**<sup>®</sup>  
Experience Extraordinary

FOR LEASE - 36,618 SF AVAILABLE

# 1301 EAST ARAPAHO ROAD

RICHARDSON, TEXAS 75081

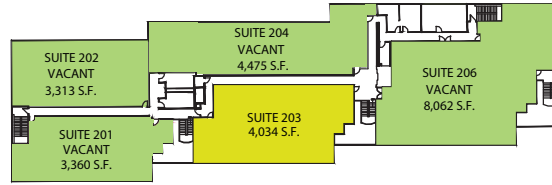

1301 ARAPAHO ROAD, SECOND FLOOR

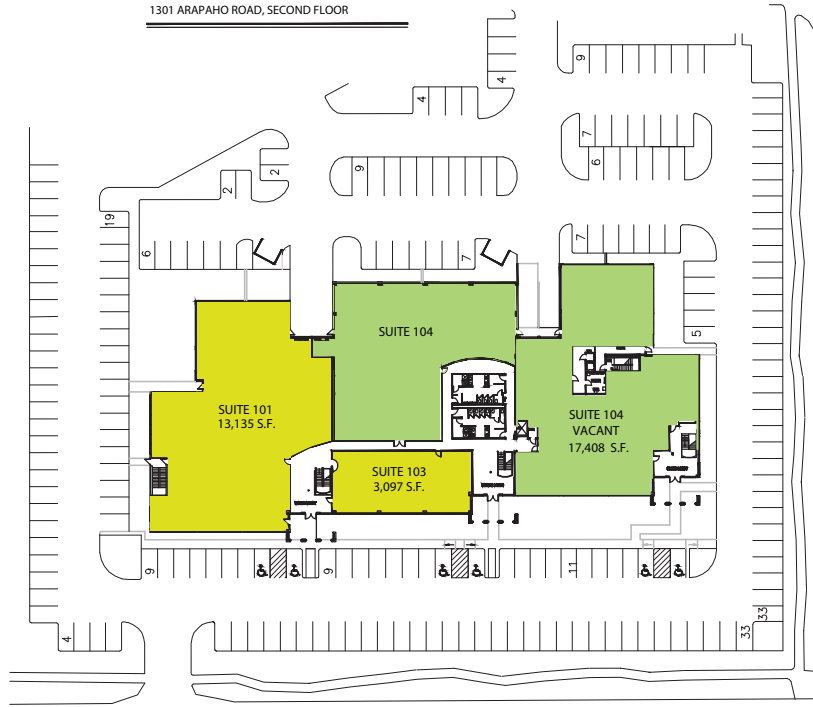

PRESIDENTIAL DR  
1301 ARAPAHO ROAD, FIRST FLOOR



NORTH

#### AREA SUMMARY

TOTAL SQUARE FOOTAGE:	56,884 S.F.
FIRST FLOOR:	33,640 S.F.
SECOND FLOOR:	23,244 S.F.

#### PARKING SUMMARY

PROVIDED:	219 SPACES
-----------	------------

#### READING KEY

- = VACANT
- = LEASED

## WILSON - RICHARDSON

1301 ARAPAHO DRIVE

RICHARDSON, TEXAS 75081

#### FOR INFORMATION CONTACT

Joe Whitmer

214.446.4556

joe.whitmer@transwestern.com

Emily Rankin

214.446.4571

emily.rankin@transwestern.com

**TRANSWESTERN**<sup>®</sup>  
Experience Extraordinary