

PACIFIC COMMONS

17821 Pacific Avenue S, Spanaway, WA 98387

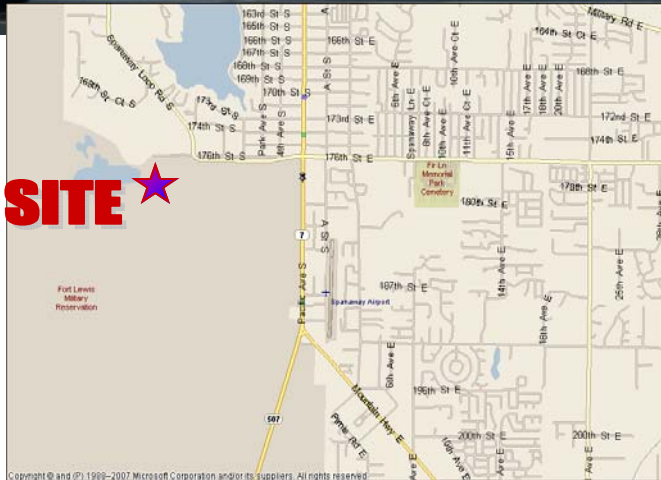

Pylon Signage Available



- ◆ Large, shopping center with a strong customer base located in Spanaway
- ◆ Project has excellent traffic flow and is convenient to South Hill and Canyon Road Residents
- ◆ Anchor Space: Rate is negotiable - Please call for details.
- ◆ 43,000 cars per day on Pacific Ave. S
- ◆ Shop Space: \$18.00 per square foot on shop spaces, plus NNN

2010 Demographics	Daytime
Total Population	344,566
Average HH Income	\$54,156

Andy Jessberger (253) 471-5507

andy@firstwesternproperties.com



First Western Properties - Tacoma, Inc. | www.fwp-inc.com
 6402 Tacoma Mall Blvd, Tacoma, WA 98409 | 253-472-0404 Phone | 253-472-0541 Fax



PACIFIC COMMONS

17821 Pacific Ave. S, Spanaway, WA 98387

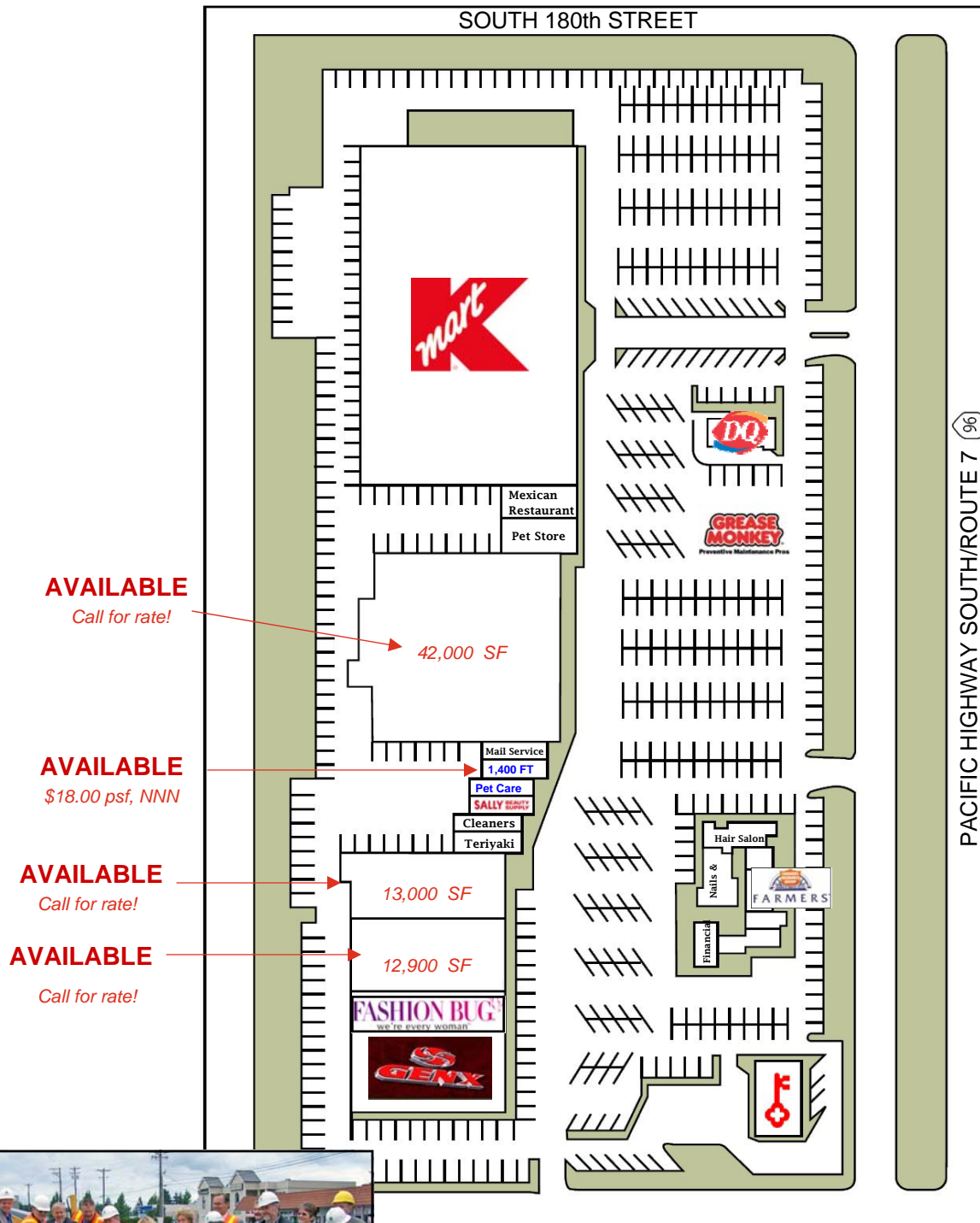

**SR 704 Cross Base Highway
 Ground Breaking Ceremony
 July 30, 2008**