

# George W. Dunne Cook County Office Building

69 W. Washington Street, Chicago, IL



For more information or to arrange a tour:  
Ivan Boone  
312 893 0470 - [iboone@frontiercommercial.com](mailto:iboone@frontiercommercial.com)

350 N. Orleans St. | Suite 9000N | Chicago, Illinois 60654



# George W. Dunne Cook County Office Building

69 W. Washington Street, Chicago, IL

**Current Space Available:** Office Space (full floors)  
Suite 3100 – 20,818 sqft  
Suite 1700 – 20,039 sqft  
Suite 1600 – 20,039 sqft

Retail Pedway Space  
Suite LL14 – 1,745 sqft  
Suite LL15 – 724 sqft

**Property Information:**

- 720,976 total square footage
- Renovated in 1990
- LEED Gold certified for operating efficiency
- Institutionally owned and privately managed
- 9 foot finished ceiling height for office space

**Location Benefits:**

- Centrally located
- Adjacent to City Hall and key government buildings.
- Pedway access to CTA, retail and public services.
- 1,100 visitors per day
- 2,000 employees on site
- Conference Center & Employee Café
- On-site: Subway, Citibank, CVS Pharmacy, sundry store
- IL Secretary of State – vital records center

**Asking Rent:** Available upon request.



**For more information or to arrange a tour:**

Ivan Boone  
312 893 0470 - [iboone@frontiercommercial.com](mailto:iboone@frontiercommercial.com)

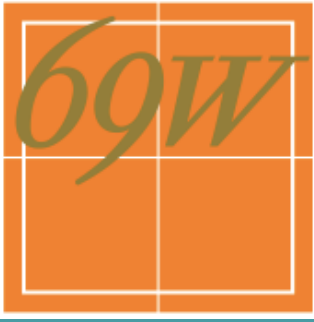

# George W. Dunne Cook County Office Building

69 W. Washington Street, Chicago, IL

**Suite 3100 – 20,818 square feet**

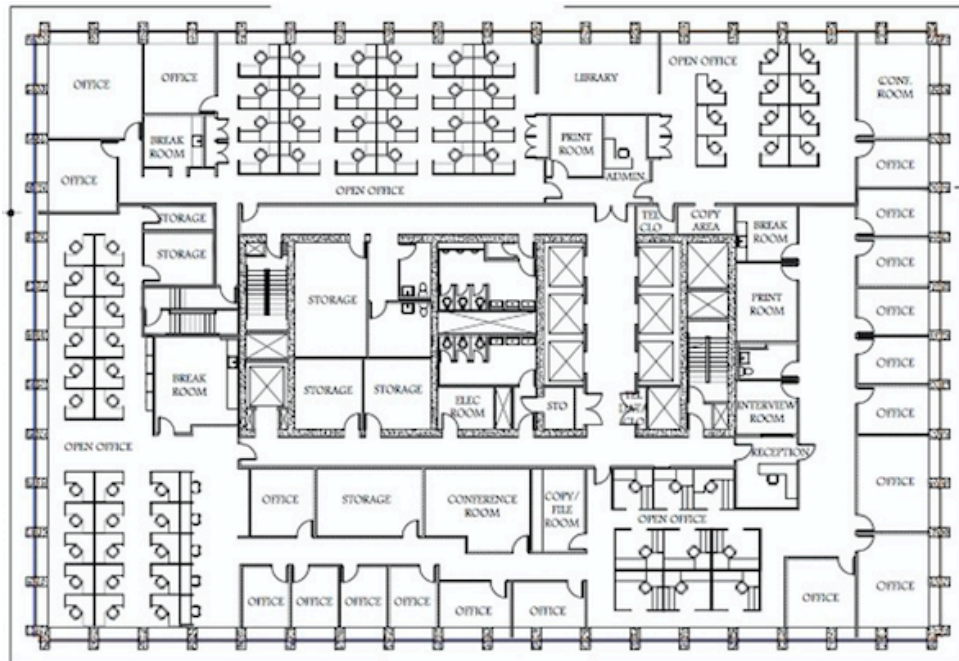

For more information or to arrange a tour:  
Ivan Boone  
312 893 0470 - [iboone@frontiercommercial.com](mailto:iboone@frontiercommercial.com)

350 N. Orleans St. | Suite 9000N | Chicago, Illinois 60654



# George W. Dunne Cook County Office Building

69 W. Washington Street, Chicago, IL

**Suite 1700 – 20,039 square feet**

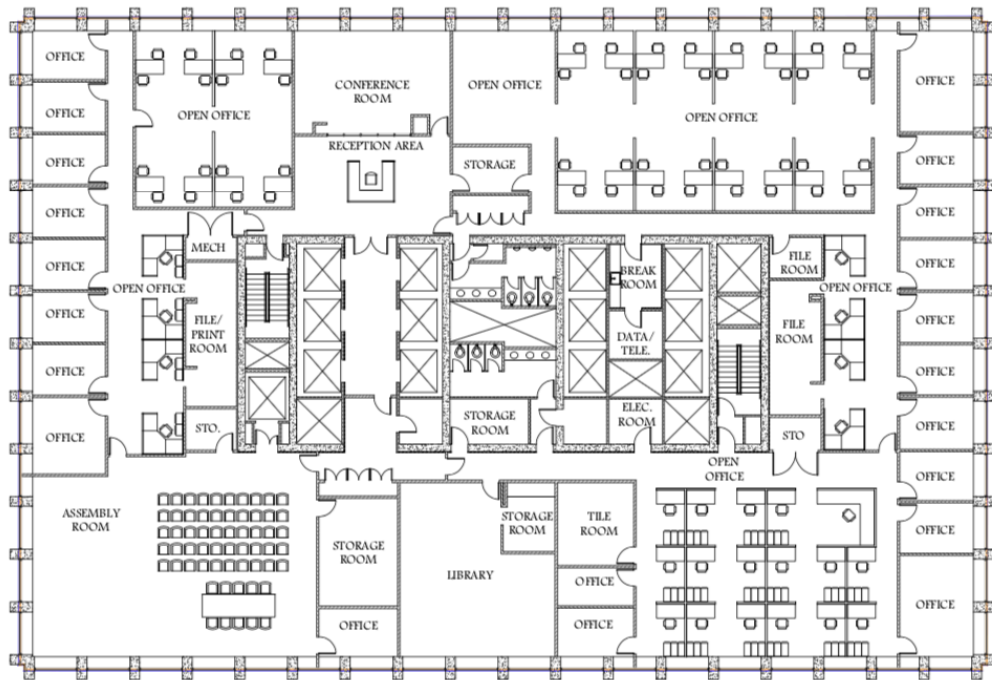

For more information or to arrange a tour:  
Ivan Boone  
312 893 0470 - [iboone@frontiercommercial.com](mailto:iboone@frontiercommercial.com)

350 N. Orleans St. | Suite 9000N | Chicago, Illinois 60654

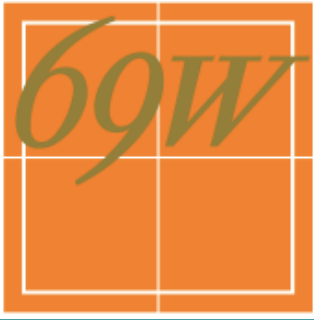

# George W. Dunne Cook County Office Building

69 W. Washington Street, Chicago, IL

**Suite 1600 – 20,039 square feet**

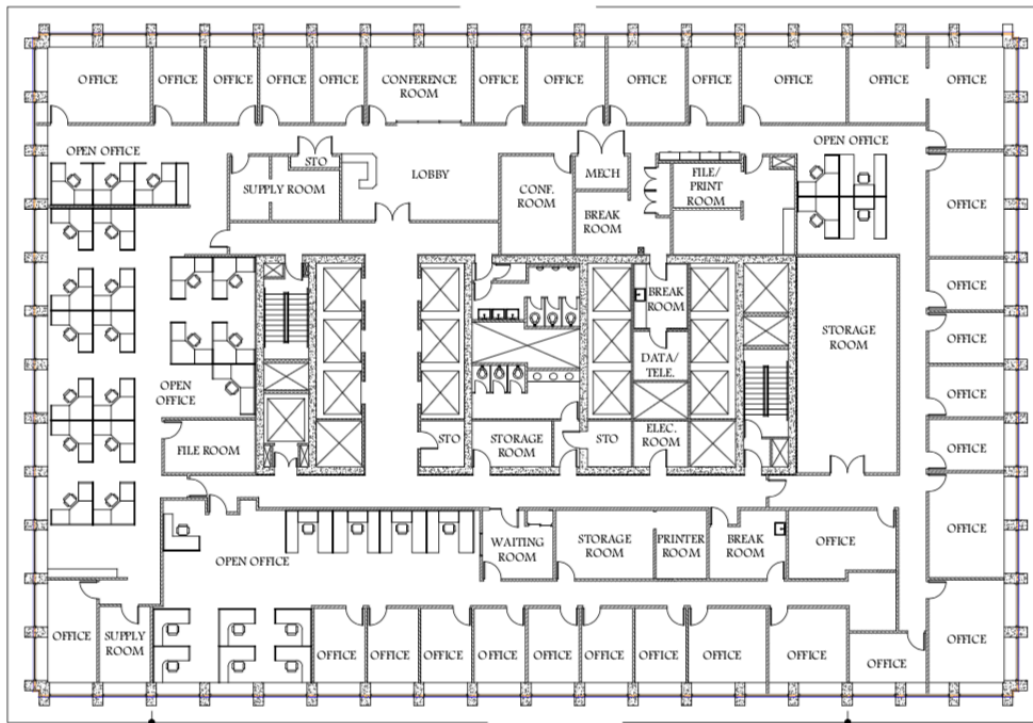

For more information or to arrange a tour:  
Ivan Boone  
312 893 0470 - [iboone@frontiercommercial.com](mailto:iboone@frontiercommercial.com)



# George W. Dunne Cook County Office Building

69 W. Washington Street, Chicago, IL

## Base Plan - Column Free High Rise Floor

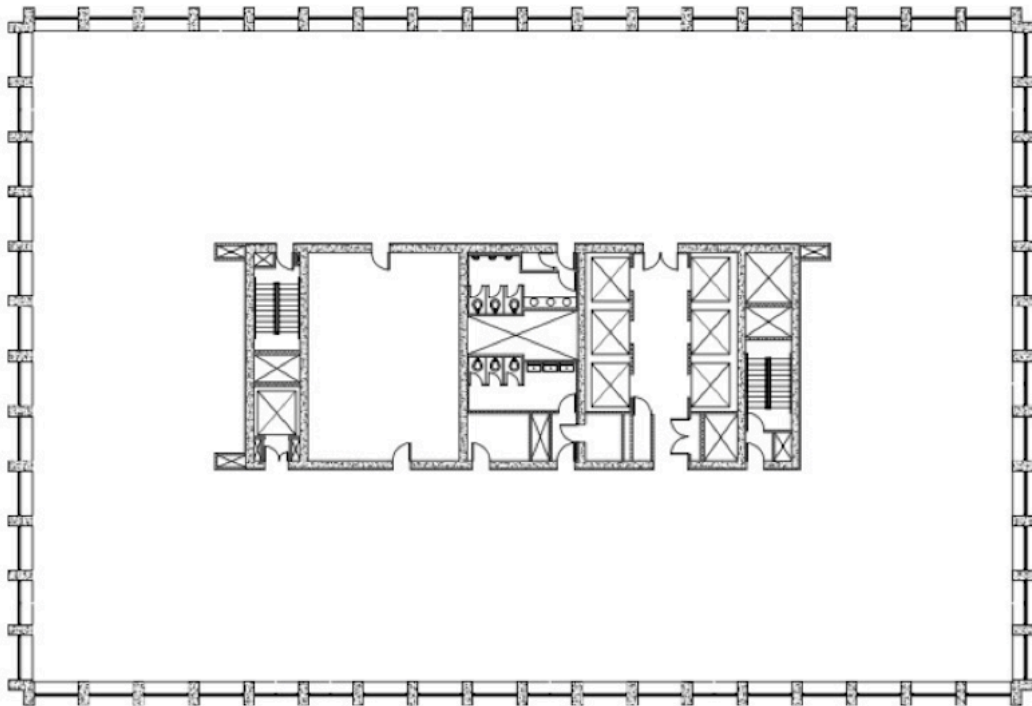

For more information or to arrange a tour:  
Ivan Boone  
312 893 0470 - [iboone@frontiercommercial.com](mailto:iboone@frontiercommercial.com)

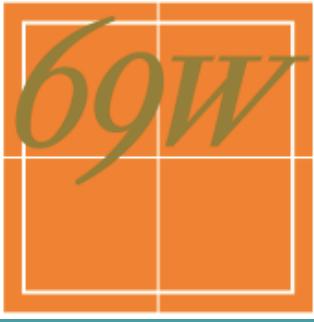

# George W. Dunne Cook County Office Building

69 W. Washington Street, Chicago, IL

## Pedway Retail or Office Space

- LL14 - 1,745 square feet
- LL15 - 724 square feet
- Food or Retail use
- 9' Ceiling height
- 160 amps/3 phase 208/220 service
- 2,000 employees on site
- 1,100 visitors per day

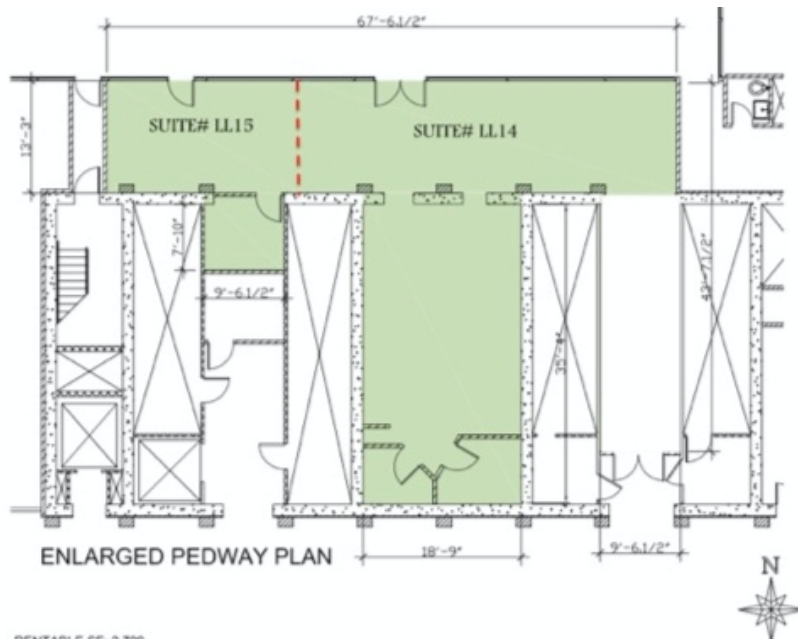

For more information or to arrange a tour:  
Ivan Boone  
312 893 0470 - [iboone@frontiercommercial.com](mailto:iboone@frontiercommercial.com)

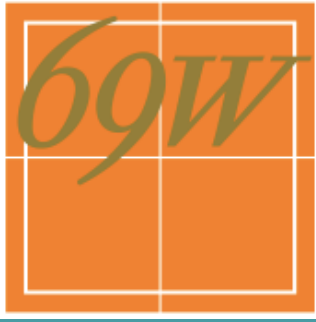

# George W. Dunne Cook County Office Building

69 W. Washington Street, Chicago, IL

## General Property Information

The George W. Dunne Cook County Office Building is located at the southwest corner of Dearborn and Washington Streets in the heart of Chicago's central business district. The building offers direct access to downtown Chicago's popular underground pedestrian pedway, with its year-round, weather proof link to CTA subway trains, retail shopping, the courts, other government offices, including the Richard J. Daley Center, Thompson Center and the Chicago City Hall/Cook County Building, as well as the financial district, business clubs, cultural institutions, and numerous dining options. The centrally situated Cook County Office Building is perfectly located for convenient access for not only the hundreds of Cook County, City and State tenants who commute to work, but the thousands of County citizens who use the various services and departments at the building on a daily basis.

The 37-story building, which was purchased by the county in 1997, was designed by Skidmore, Owings & Merrill in 1963, completed in 1965 and features floor-to-ceiling windows that create extraordinary interior light, a productive work environment and wide-open views of the city. A classic example of the international-style of architecture, the 720,976 square foot building contains 650,000 square feet of office space, 23,000 square feet of retail space, 18,000 square feet of storage space and a 9-story annex, affectionately referred to as the "bustle." Built primarily of poured concrete, the unique "waffle iron" design was the first concrete structure of its kind to be built with a column-free design, which affords extremely efficient, practical office layouts for the 20,000 square foot floor plates. The impressive, 26 foot high, floor-to-ceiling glass-enclosed lobby, clad in Italian travertine, is home to Citicorp's retail banking facility and provides direct escalator access to the underground pedestrian pedway system. The Cook County Office Building also has the distinction of being home to the world class sculpture by Spanish artist Joan Miro, "Miro's Chicago" which was unveiled in 1981 and is located in the building's adjacent western plaza overlooking Chicago's famous Picasso sculpture.

The Cook County Office Building is also home to the Cook County/City of Chicago Child Care Center, the only day-care facility located in the Central Business District with two outdoor play areas. Designed to meet or exceed all criteria set forth by the National Association for the Education of Young Children, the facility also provides special enrichment programs such as health and wellness programs, computers, music, singing and rhythm instruments as well as creative movement and physical fitness. The day-care center services not only Cook County and City of Chicago employees, it is open to enrollment by community families as well.



**For more information or to arrange a tour:**

Ivan Boone

312 893 0470 - [iboone@frontiercommercial.com](mailto:iboone@frontiercommercial.com)