

FOR LEASE

SEC 16th Street & Indian School Road

4025 N. 16TH STREET, PHOENIX, ARIZONA 85016

RETAIL



PROPERTY INFO

- + Goodwill anchored center
- + Direct access to SR 51
- + Outstanding visibility to Indian School Road
- + Over 65,000 VPD through the intersection*
- + ±249,557 daytime population in a 3-mile radius*
- + Co-Tenants include Payless Shoesource, RadioShack/Sprint, Little Caesars and Liberty Tax Service



Demographics

	1-Mile	3-Mile	5-Mile
2017 Total Population	22,029	168,395	370,827
2017 Daytime Population	27,311	249,557	597,110
2017 Avg. Household Income	\$61,989	\$62,582	\$64,891
2017 Households	9,346	72,026	146,800

Source: Esri 2018*

Traffic Counts

16th Street	37,690 vpd
Indian School Road	25,157 vpd
Total	62,847 vpd

Source: MPSI Estimate 2015



CBRE

FOR LEASE

SEC 16th Street & Indian School Road

4025 N. 16TH STREET, PHOENIX, ARIZONA 85016

RETAIL

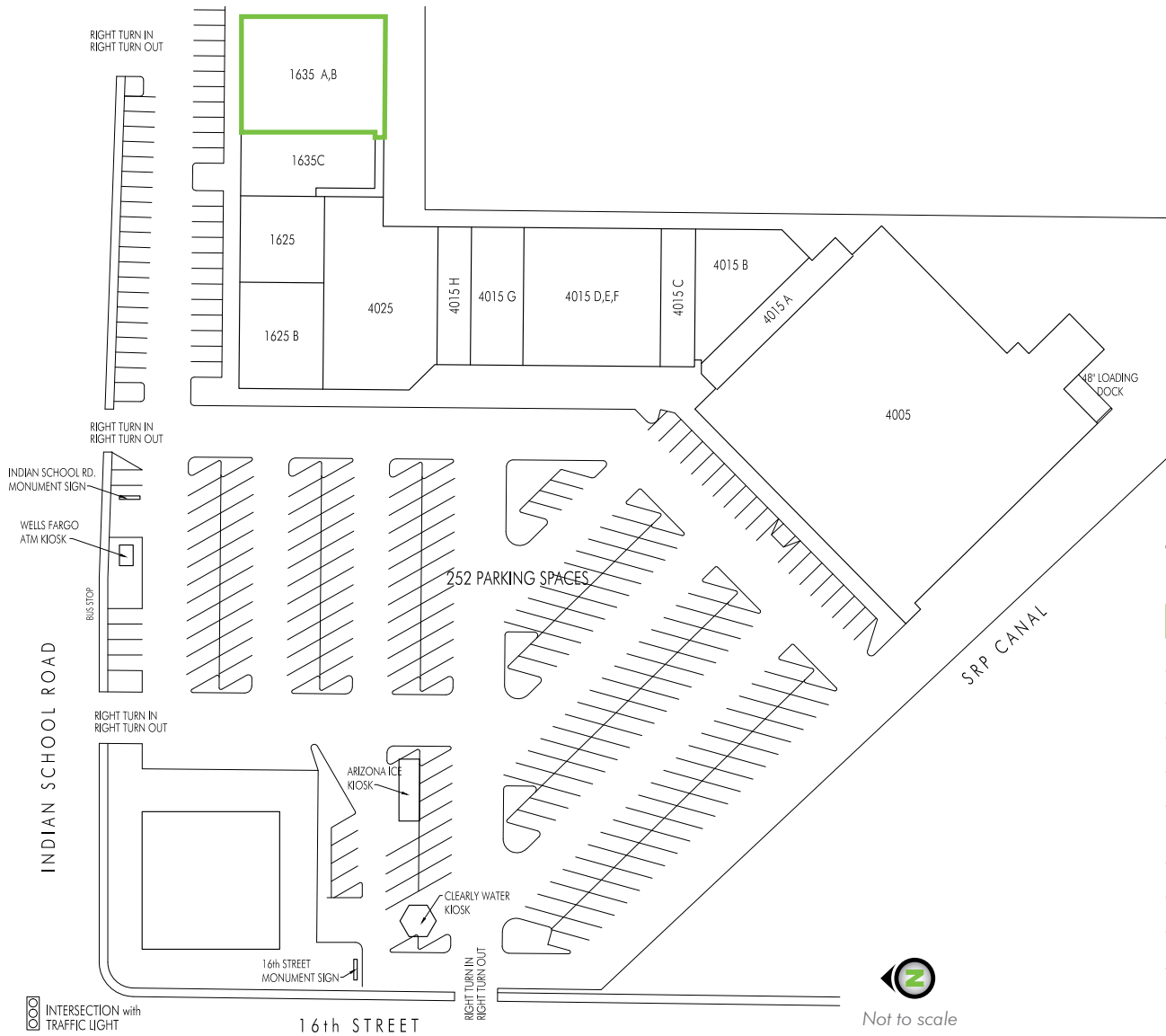

#	Tenant	± SQ. FT.
1625 & 1625 B	GG&D Motor Vehicle Services	
1635 A,B	Available	±2,704 - 5,500
1635 C	Liberty Tax Service	
4005	Goodwill	
4015 A	Goodwill	
4015 B	Goodwill	
4015 C	Ken's Nails	
4015 D,E, & F	Phoenix Shanti Group	
4015 G	RadioShack/Sprint	
4015 H	Little Ceasars	
4025	Arizona Art Supply	

FOR LEASE

SEC 16th Street & Indian School Road

4025 N. 16TH STREET, PHOENIX, ARIZONA 85016

RETAIL



CONTACT US

Chris Ryan

+1 602 735 5828
chris.ryan3@cbre.com

Bill Bones

+1 602 735 5215
bill.bones@cbre.com

© 2018 CBRE, Inc. All rights reserved. This information has been obtained from sources believed reliable, but has not been verified for accuracy or completeness. You should conduct a careful, independent investigation of the property and verify all information. Any reliance on this information is solely at your own risk. CBRE and the CBRE logo are service marks of CBRE, Inc. and/or its affiliated or related companies in the United States and other countries. All other marks displayed on this document are the property of their respective owners. Photos herein are the property of their respective owners and use of these images without the express written consent of the owner is prohibited.

CBRE