

FOR SUBLEASE

# The Pettygrove Building

1400 NW 22nd Avenue / Portland, OR 97210



**MARK CARNESE**

Executive Director

+1 503 279 1764

[mark.carnese@cushwake.com](mailto:mark.carnese@cushwake.com)

**DOUG DEURWAARDER**

Executive Director

+1 503 279 1752

[doug.deurwaarder@cushwake.com](mailto:doug.deurwaarder@cushwake.com)

**GRANT GUERNSEY**

Associate Broker

+1 503 279 1724

[grant.guernsey@cushwake.com](mailto:grant.guernsey@cushwake.com)



1400 NW 22ND AVE  
Portland, Oregon 97210

## SECOND FLOOR

**Second Floor: 9,144 RSF,  
divisible to 2,500 SF**

### Property Highlights

- Highly visible corner facade with wood laminate vestibule
- Excellent NW District location offers loads of amenities, walking distance to New Seasons Market & easy access to the Pearl
- Home to iconic Northwest brand Tillamook's new Portland office.
- New Northwest chic construction: high ceilings, oversized windows, and exposed wood beams
- Parking available
- Rate: \$25.50 NNN (NNNs estimated to be \$7.50)

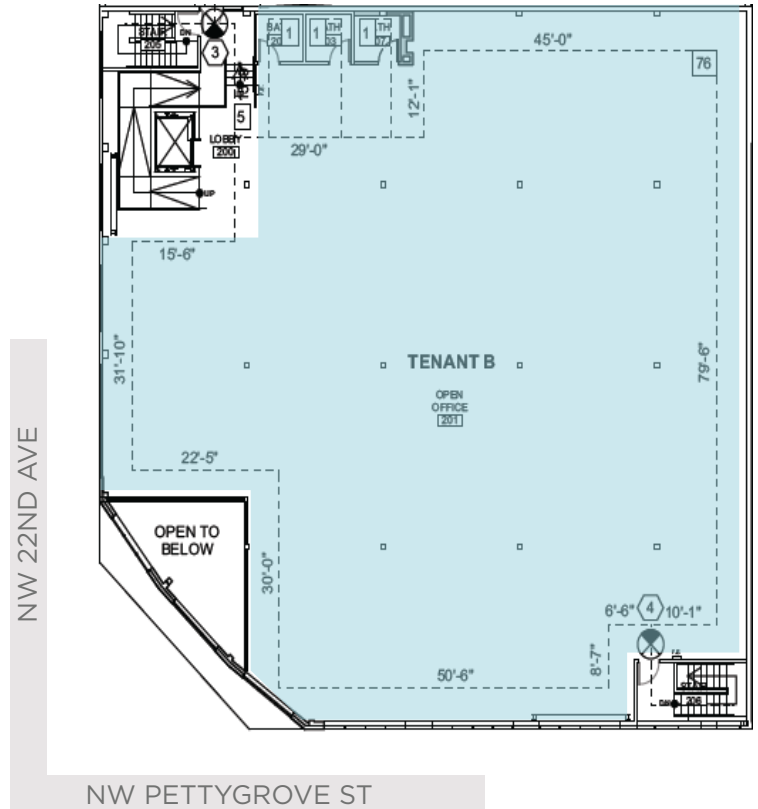



AMENITY MAP

## SLABTOWN THE BEST NEW NEIGHBORHOOD IN PORTLAND

- |                                    |                                 |                                      |
|------------------------------------|---------------------------------|--------------------------------------|
| <b>● Restaurant/Bar</b>            | <b>● Coffee</b>                 | <b>● Services</b>                    |
| <b>R1</b> The Matador              | <b>C1</b> Starbucks             | <b>S1</b> CVS Pharmacy               |
| <b>R2</b> Grassa                   | <b>C2</b> Vivace                | <b>S2</b> Zoom Care                  |
| <b>R3</b> Moberi                   | <b>C3</b> New Seasons Market    | <b>S3</b> Dove Lewis Animal Hospital |
| <b>R4</b> Bull Run Distillery      | <b>C4</b> Good Coffee           | <b>S4</b> The Joint Chiropractic     |
| <b>R5</b> Muse Winebar             | <b>● Fitness &amp; Health</b>   | <b>S5</b> Consolidated Community CU  |
| <b>R6</b> St. Jack                 | <b>F1</b> Studio Blue Pilates   |                                      |
| <b>R7</b> Breakside Brewery        | <b>F2</b> Core Power Yoga       |                                      |
| <b>R8</b> The Solo Club            | <b>F3</b> Orange Theory Fitness |                                      |
| <b>R9</b> Besaws                   |                                 |                                      |
| <b>R10</b> Lucky Labrador Brew Pub |                                 |                                      |



...within immediate walking distance.



# TRANSPORTATION MAP

The Pettygrove Building



Walk Score 96



BikeScore 98



2 min

Streetcar Stop

25 min

Union Station

2 min

Line 77

20 min

MAX Red Line



1 min

7 min

1 min

4 min



North/South Streetcar Line



77 Bus Line



B Loop Streetcar Line



MAX Red Line



MAX Yellow Line



MAX Green Line

## MARK CARNESE

Executive Director

+1 503 279 1764

[mark.carnese@cushwake.com](mailto:mark.carnese@cushwake.com)

Licensed In OR & WA

200 SW Market Street, Suite 200

Portland, OR 97201

Main +1 503 279 1700

Fax +1 503 274 6512

[cushmanwakefield.com/Portland](http://cushmanwakefield.com/Portland)

## DOUG DEURWAARDER

Executive Director

+1 503 279 1752

[doug.deurwaarder@cushwake.com](mailto:doug.deurwaarder@cushwake.com)

Licensed In OR & WA

## GRANT GUERNSEY

Associate Broker

+1 503 279 1724

[grant.guernsey@cushwake.com](mailto:grant.guernsey@cushwake.com)

Licensed In OR



# CUSHMAN & WAKEFIELD

Cushman & Wakefield Copyright 2018. No warranty or representation, express or implied, is made to the accuracy or completeness of the information contained herein, and same is submitted subject to errors, omissions, change of price, rental or other conditions, withdrawal without notice, and to any special listing conditions imposed by the property owner(s). As applicable, we make no representation as to the condition of the property (or properties) in question.