

**FOR LEASE**

# 34,240 SF Industrial Building

4650 Tiedeman Road, Brooklyn, OH 44144



## PROPERTY OVERVIEW

- 34,240 total SF
- Warehouse: 31,540 SF
- Office: 2,700 SF
- Located on 3.52 acres
- 50+ Parking spots
- 2 dock doors & 1 drive-in door
- Clear height: 17'
- Heavy power, 240/480 3 phase
- Locker rooms: Men's and Women's
- Lunch room
- New Lighting
- Roof replaced 5 years ago
- **Lease rate: \$5.25/SF, NNN**

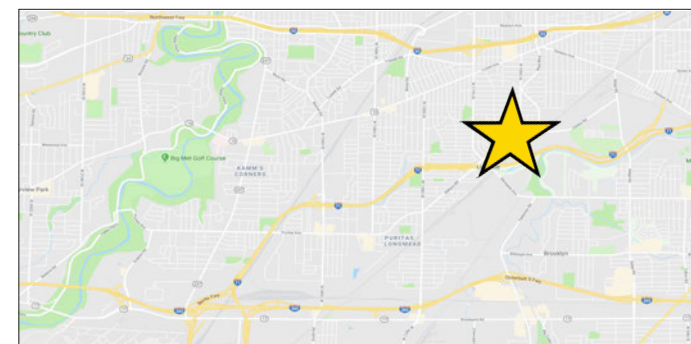

[View in Google Maps](#)



The information submitted herein is not guaranteed. Although obtained from reliable resources, it is subject to errors, omissions, prior sale and withdrawal from the market without notice. Broker has made no investigation and makes no representation of the property.

William P Nice, Jr.

216.839.2010

BillNice@HannaCRE.com

David Wagner

216.839.2002

DavidWagner@HannaCRE.com

**FOR LEASE**

# 34,240 SF Industrial Building

4650 Tiedeman Road, Brooklyn, OH 44144

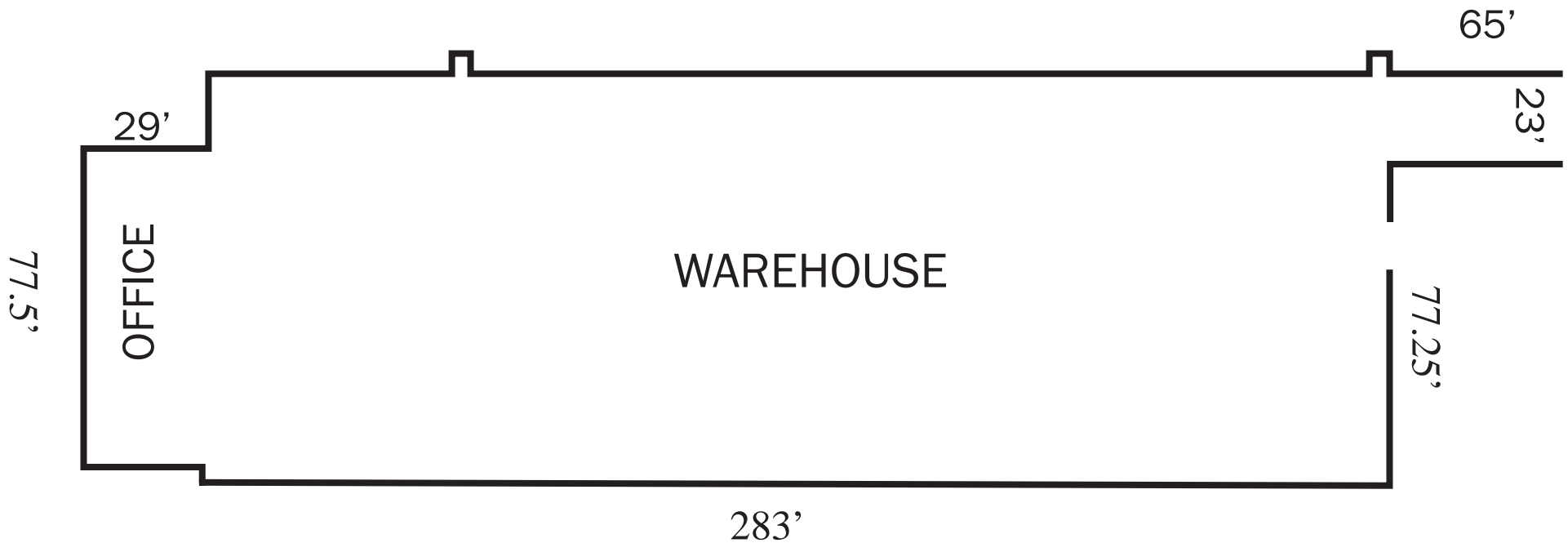

The information submitted herein is not guaranteed. Although obtained from reliable resources, it is subject to errors, omissions, prior sale and withdrawal from the market without notice. Broker has made no investigation and makes no representation of the property.

William P Nice, Jr.

📞 216.839.2010

✉ BillNice@HannaCRE.com

David Wagner

📞 216.839.2002

✉ DavidWagner@HannaCRE.com