



## 2791 CIRCLEPORT DR, ERLANGER, KY 41018 – BOONE COUNTY AVAILABLE FOR LEASE

### PROPERTY DETAILS



**5,281 Office SqFt**

<b>Total Office SqFt:</b>	5,281 SqFt
<b>Common Area:</b>	740 SqFt
<b>Ceiling Heights:</b>	9'+
<b>Construction:</b>	Masonry/brick over steel frame
<b>Parking Lot:</b>	10 spaces

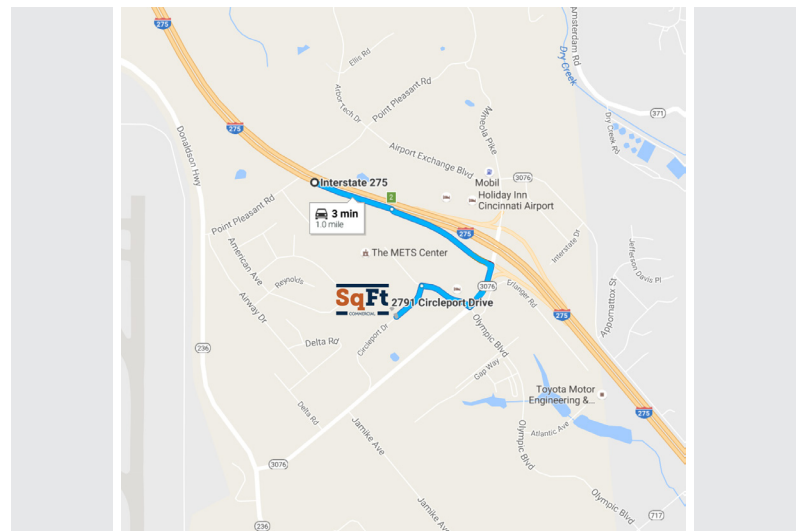

**CLICK HERE FOR PHOTOS**

### PROPERTY HIGHLIGHTS

- Adjacent to CVG and located half mile to I-275
- Nearby amenities include hotels, restaurants, and retail Mineola Pike
- No city earnings tax

**Roddy MacEachen**

(513) 739-3985

Roddy@SqFtCommercial.com

**Jared Wagoner**

(812) 890-1768

Jared@SqFtCommercial.com



2791 CIRCLEPORT DR, ERLANGER, KY 41018



## AERIAL & AVAILABILITY

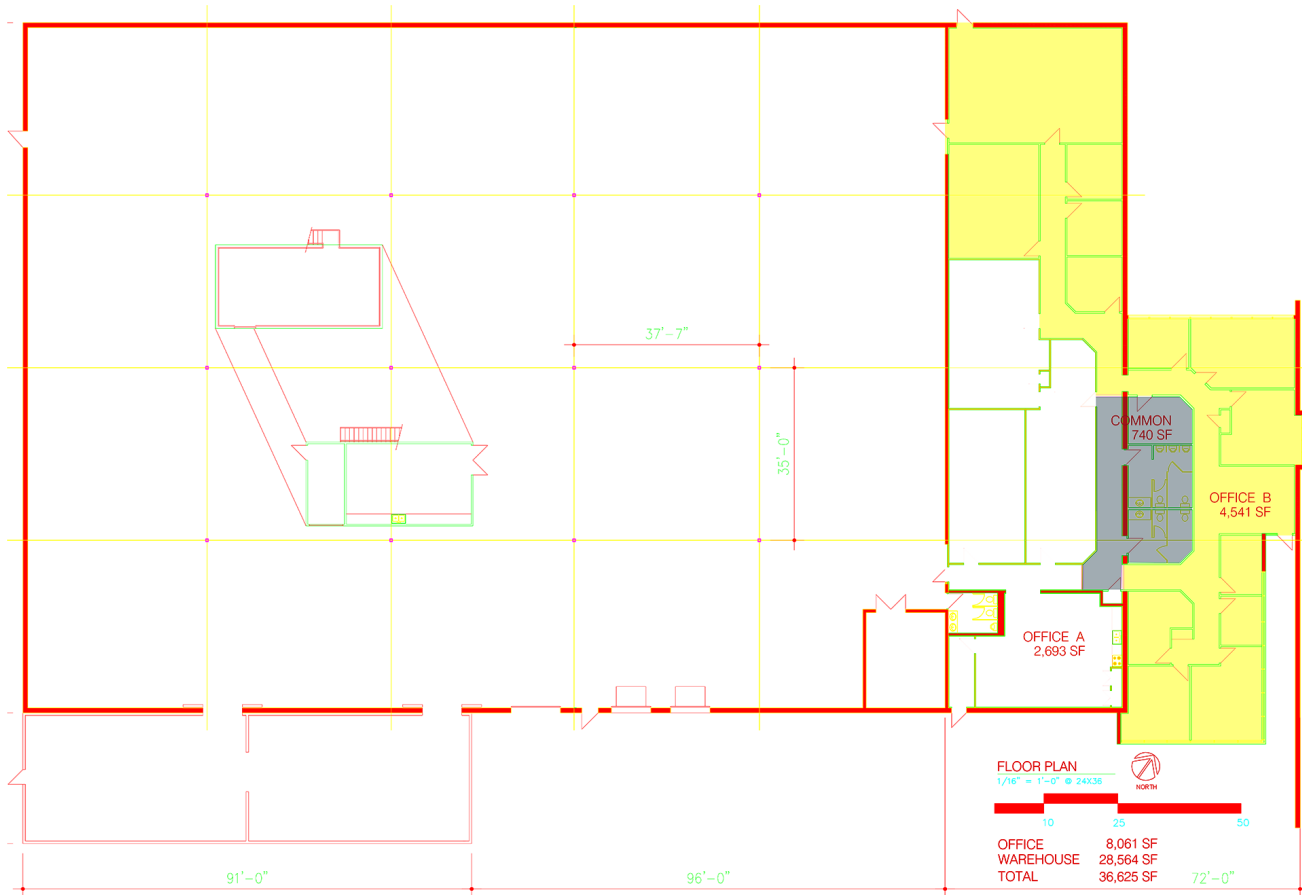

**Roddy MacEachen**  
(513) 739-3985  
Roddy@SqFtCommercial.com

**Jared Wagoner**  
(812) 890-1768  
Jared@SqFtCommercial.com



**2791 CIRCLEPORT DR, ERLANGER, KY 41018**



## **ADDITIONAL PHOTOS**



**Roddy MacEachen**  
(513) 739-3985  
Roddy@SqFtCommercial.com

**Jared Wagoner**  
(812) 890-1768  
Jared@SqFtCommercial.com

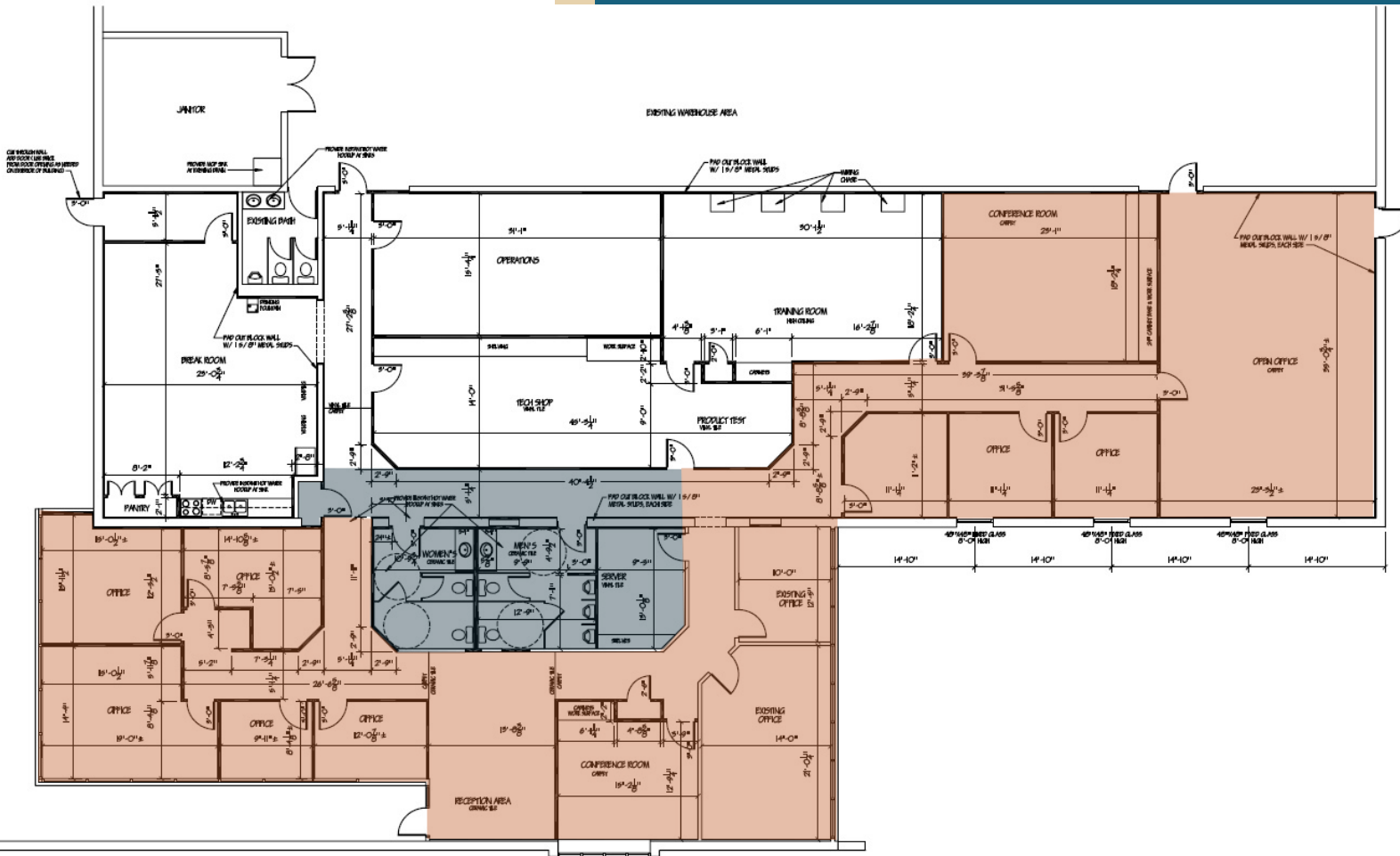

## OFFICE FLOOR PLAN

© 2017 SqFt Commercial. This information has been obtained from sources believed reliable. We have not verified it and make no guarantee, warranty or representation about it. Any projections, opinions, assumptions or estimates used are for example only and do not represent the current or future performance of the property. You and your advisors should conduct a careful, independent investigation of the property to determine to your satisfaction the suitability of the property for your needs.

**Roddy MacEachen**  
 (513) 739-3985  
 Roddy@SqFtCommercial.com

**Jared Wagoner**  
 (812) 890-1768  
 Jared@SqFtCommercial.com