

KITCHEN EQUIPMENT PLAN

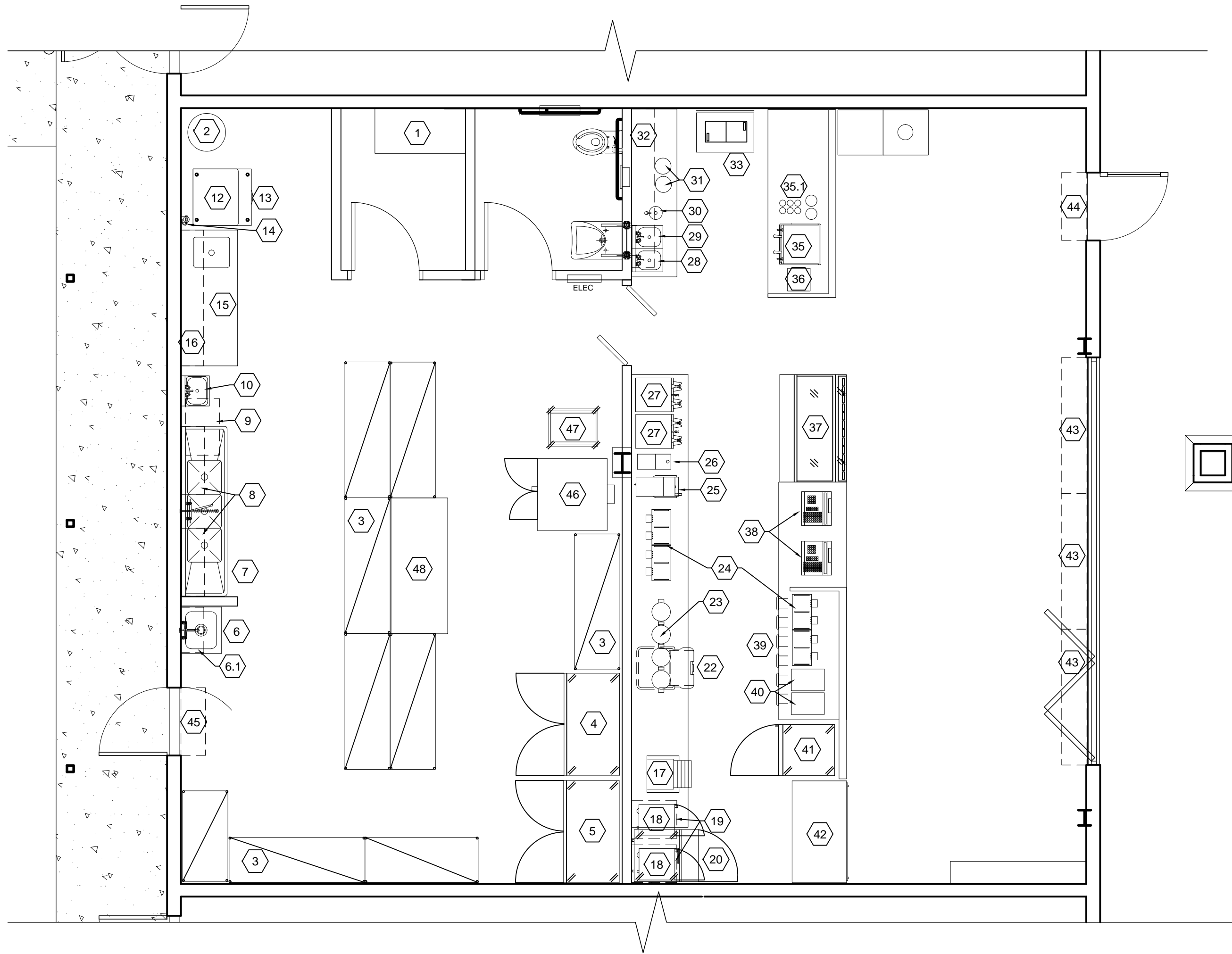

EQUIPMENT SCHEDULE

ITEM NUMBER	QUANTITY	DESCRIPTION	WATER		WASTE		GAS		ELECTRICAL				REMARKS	
			COLD	HOT	QUANTITY	DIRECT	INDIRECT	PIPE SIZE	BTU IN (KBTU)	VOLTAGE	PHASE	AMPS		CORD & PLUG
1	1	DESK												E.C. VERIFY POWER/TEL/DATA REQUIREMENT W/ OWNER TO BE PROVIDED AND INSTALLED BY P.C.
2	1	HOT WATER TANK			VERIFY			VERIFY	VERIFY					
3	1	SHELVING LOT												
4	1	REFRIGERATOR, REACH-IN, 2 SECTIONS							115	1	10	X		
5	1	FREEZER, REACH-IN, 2 SECTIONS							115	1	11	X		
6	1	MOP SINK & FAUCET	1/2"	1/2"	1	2"								
6.1	1	WALL SHELF												G.C. TO PROVIDE WALL BLOCKING
7	1	SINK, (3) THREE COMPARTMENT	1/2"	1/2"	3	1.5"								G.C. TO PROVIDE WALL BLOCKING
8	2	WALL SHELF												G.C. TO PROVIDE WALL BLOCKING
9	1	GREASE TRAP				1	3"							P.C. TO VERIFY SIZE AND LOCATION RECESSED IN FLOOR PREFERRED
10	1	HAND SINK	1/2"	1/2"	1	1.5"								G.C. TO PROVIDE WALL BLOCKING
11	1	SPARE NUMBER												
12	1	ICE MAKER, CUBE-STYLE	3/8"		1	3/4"		208	1	12		X		PLUMB THROUGH #14 FILTER
13	1	ICE BIN				1	3/4"							
14	1	WATER FILTER FOR ICE MACHINE	3/8"											
15	1	WORK TABLE W/ PREP SINK	1/2"	1/2"	1	1.5"								E.C. PROVIDE UTILITY OUTLET @ 48" AFF
16	1	WALL SHELF												G.C. TO PROVIDE WALL BLOCKING
17	1	TOASTER, CONVEYOR							208	1	14	X		NEMA 6-20P
18	2	MICROWAVE OVEN							208	1	17	X		NEMA 6-20P
19	2	WALL SHELF, MICROWAVE												G.C. TO PROVIDE WALL BLOCKING
20	1	REFRIGERATED SANDWICH UNIT							115	1	5	X		
21	1	SPARE NUMBER												
22	1	ICE BIN, MOBILE												
23	4	TEA/COFFEE DISPENSER												NO CONNECTION REQUIRED
24	4	SATELLITE COFFEE WARMER							115	1	2	X		
25	1	ICED TEA / COFFEE BREWER	1/4"						120/208	1	20	X		3 WIRE + GROUND NEMA L14-30P
26	1	COFFEE GRINDER							115	1	10	X		
27	2	COFFEE BREWER WITH SATELLITES	1/4"						120/240	1	29	X		3 WIRE + GROUND NEMA L14-30P
28	1	DUMP SINK, W/ SIDE SPLASHES	1/2"	1/2"	1	1.5"								
29	1	HAND SINK, W/ SIDE SPLASHES	1/2"	1/2"	1	1.5"								
30	1	DIPPERWELL & FAUCET	1/2"	1/2"	1	1.5"								
31	2	BLENDER							115	1	13	X		
32	1	WALL SHELF												G.C. TO PROVIDE WALL BLOCKING
33	1	ICE CREAM DIPPING CABINET							115	1	6	X		
34	1	SPARE NUMBER												
35	1	ESPRESSO MACHINE	3/8"		1	1/2"		208	1	24	X			NEMA L6-30P
35.1	1	ESPRESSO SYRUPS							115	1	3	X		NEMA 5-15P
36	1	ESPRESSO MILK COOLER							115	1	2	X		E.C. VERIFY CORD+PLUG WITH OWNER
37	1	BAKERY DISPLAY CASE							115	1	2	X		E.C. VERIFY REQUIREMENTS WITH OWNER
38	2	POS STATION							VERIFY					G.C. TO MOUNT
39	6	CUP DISPENSER												
40	2	MILK/CREAM DISPENSER							115	1	3	X		
41	1	REFRIGERATOR, REACH-IN, 1 SECTION							115	1	8	X		
42	1	BEVERAGE REFRIGERATOR, 2 SECTION							115	1	8	X		
43	3	AIR CURTAIN							208	1	8	X		ITEMS 43-45
44	1	AIR CURTAIN							208	1	4	X		G.C. TO PROVIDE WALL BLOCKING
45	1	AIR CURTAIN							208	1	4	X		E.C. TO WIRE DOOR SWITCHES
46	1	CONVECTION OVEN							208	3	31	X		
47	1	PAN RACK												
48	1	WORK TABLE												

NOTES:

- *PLUMBER TO LOCATE, PROVIDE & INSTALL FLOOR DRAINS AS REQUIRED
- *ELECTRICIAN TO VERIFY LIGHTING REQUIREMENTS WITH OWNER
- *ELECTRICIAN TO VERIFY PHONE & DATA REQUIREMENTS WITH OWNER
- *ELECTRICIAN TO DETERMINE LOCATION AND REQUIREMENTS FOR PANEL
- *PLUMBER AND ELECTRICIAN TO VERIFY COFFEE EQUIPMENT REQUIREMENTS WITH OWNER
- ITEMS #23-27, 35, 36, 40

General Notes

No.	Revision/Issue	Date

United Restaurant Equipment Co., Inc.
 1 Executive Park Drive
 North Billerica, MA 01862
 Tel: 978-439-5500
 Fax: 978-262-9999

Project:
 Coffee Cann 2
 Hampton, NH

Project	Sheet
Coffee Cann 2	
Date	
1/18/2013	
Scale	
1/4" = 1'-0"	