

# GANDY RETAIL

3126 W. Gandy Blvd. | Tampa, FL 33611  
RETAIL SPACE FOR LEASE



## PROPERTY HIGHLIGHTS

- **AVAILABLE SPACES:** 3,135 SF
- **ASKING RENT:** \$10.50/SF plus NNN
- Excellent visibility and access along **Gandy Blvd.**
- Surrounded by strong demographics within the trade area
- Area Retailers Include: Publix, Target, Home Depot, Sam's Club, CVS, Walgreens, Yogurtology, ABC Fine Wine & Spirits, Starbucks, & more

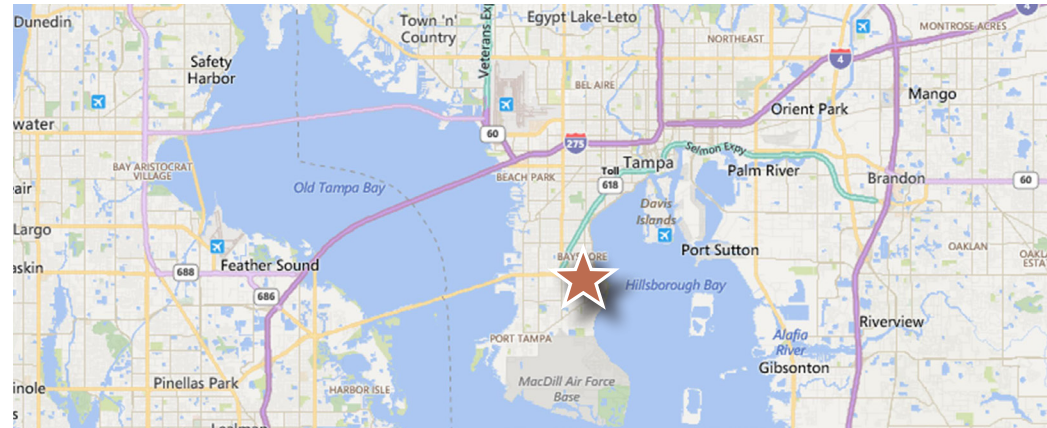

## DAILY TRAFFIC COUNTS



W. Gandy Blvd. 26,000 AADT

## POPULATION



1 Mile 14,194  
3 Mile 74,151  
5 Mile 140,417

## AVE. HOUSEHOLD INCOME



1 Mile \$119,046  
3 Mile \$107,353  
5 Mile \$99,254

## DAYTIME POPULATION



1 Mile 10,320  
3 Mile 44,749  
5 Mile 176,268

LICENSED REAL ESTATE BROKER

FranklinSt.com

**ALEX WRIGHT**  
SENIOR DIRECTOR

813.682.6135

Alex.Wright@FranklinSt.com

**JORDAN STEPHENS**  
LEASING ASSOCIATE

813.682.6126

Jordan.Stephens@FranklinSt.com

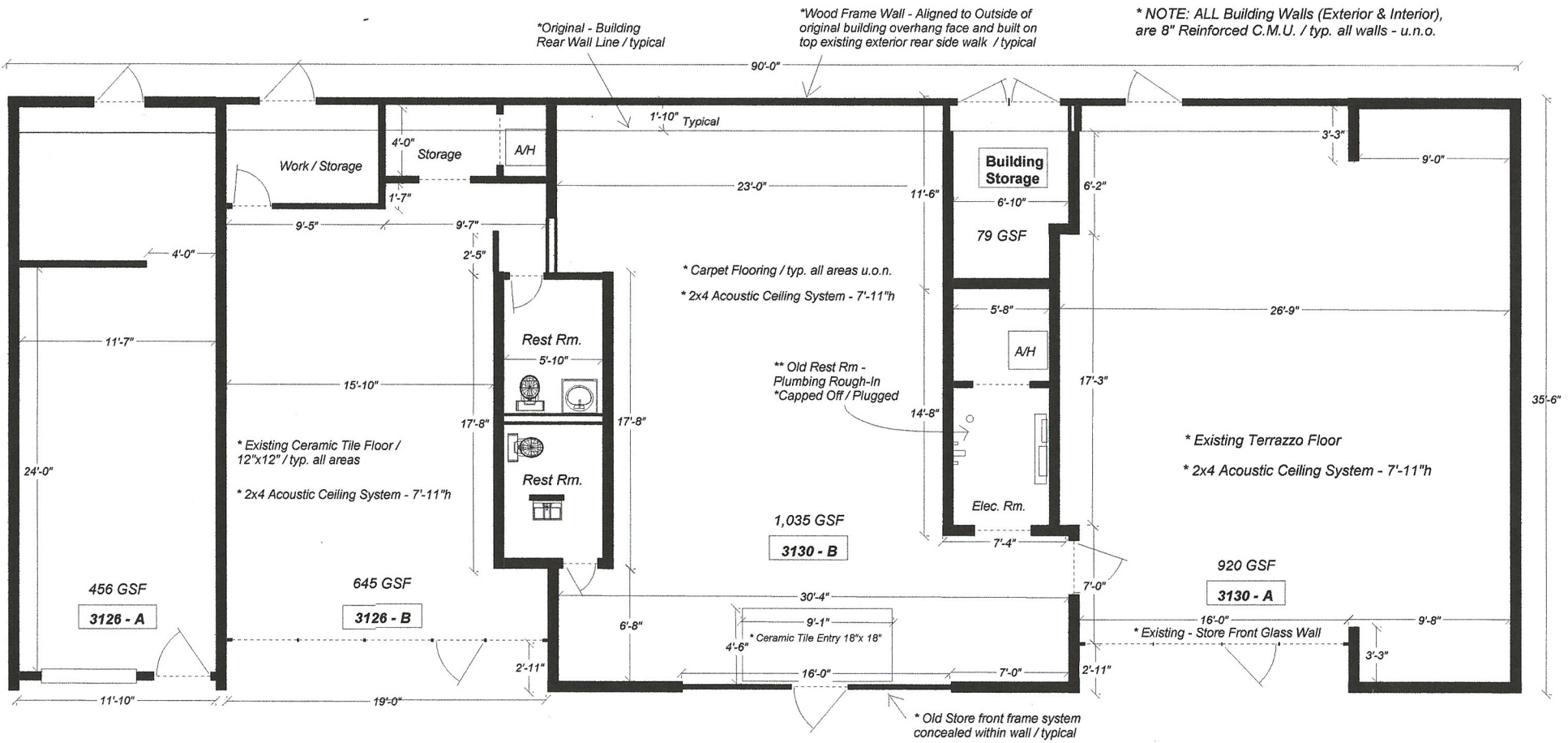

Sixth Street

**Gandy Boulevard**