

THANKSGIVINGPARK 3

2500 WEST EXECUTIVE PARKWAY LEHI, UTAH

FOR LEASE



COLDWELL
BANKER
COMMERCIAL

ADVISORS

STACK
REAL ESTATE

John S. Petersen
801.209.8805

Andrew Bybee
801.768.0500

THANKSGIVING PARK HIGHLIGHTS & SITE PLAN

- Space available - 56,216 RSF total:
Floor One - 9,091 RSF
Floor Four - 20,874 RSF
Floor Five - 26,521 RSF
- Lease rate: \$26.50/SF full service
- 5 story Class A office building
- Crown signage available
- Generous tenant improvements
- 5/1,000 USF parking ratio
- Central hub location to both Utah and Salt Lake Counties' labor pool - over 1.5 million people
- Located just .4 mile from FrontRunner Lehi Station
- Excellent I-15 and SR92 access
- LEED Silver certification
- Modern, progressive architecture with efficient floor plates
- Backup generation and infrastructure for redundant power systems
- Multiple fiber optic provider connectivity
- Surrounded by restaurants, retail shops, hotels, Larry H. Miller Megaplex Theaters and 18 hole golf course

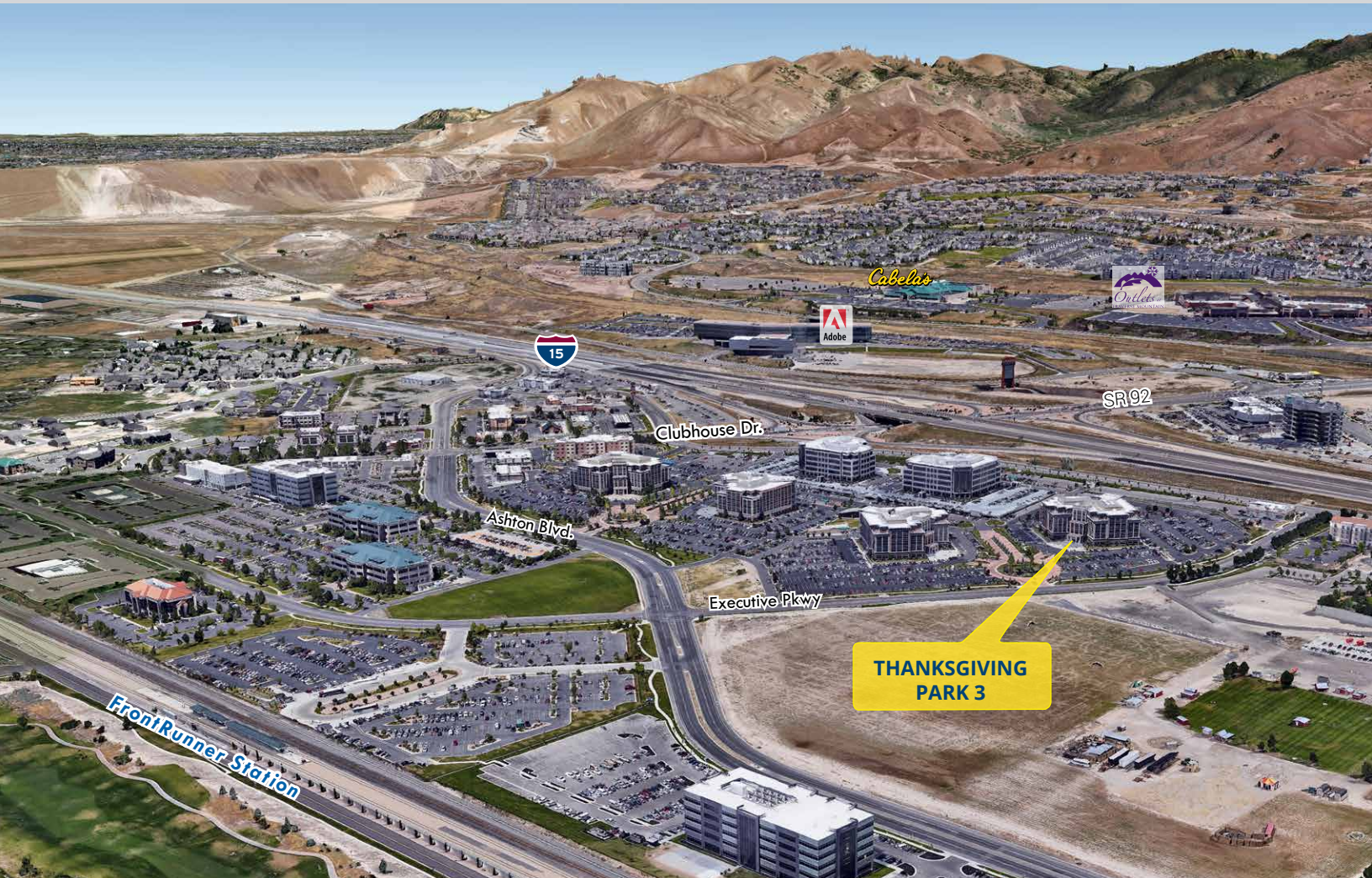

ADVISORS



John Petersen

801.209.8805

john.petersen@cbcadvisors.com

STACK

Andrew Bybee

801.768.0500

andrew@stackwithus.com

4TH FLOOR PLAN - 20,874 RSF

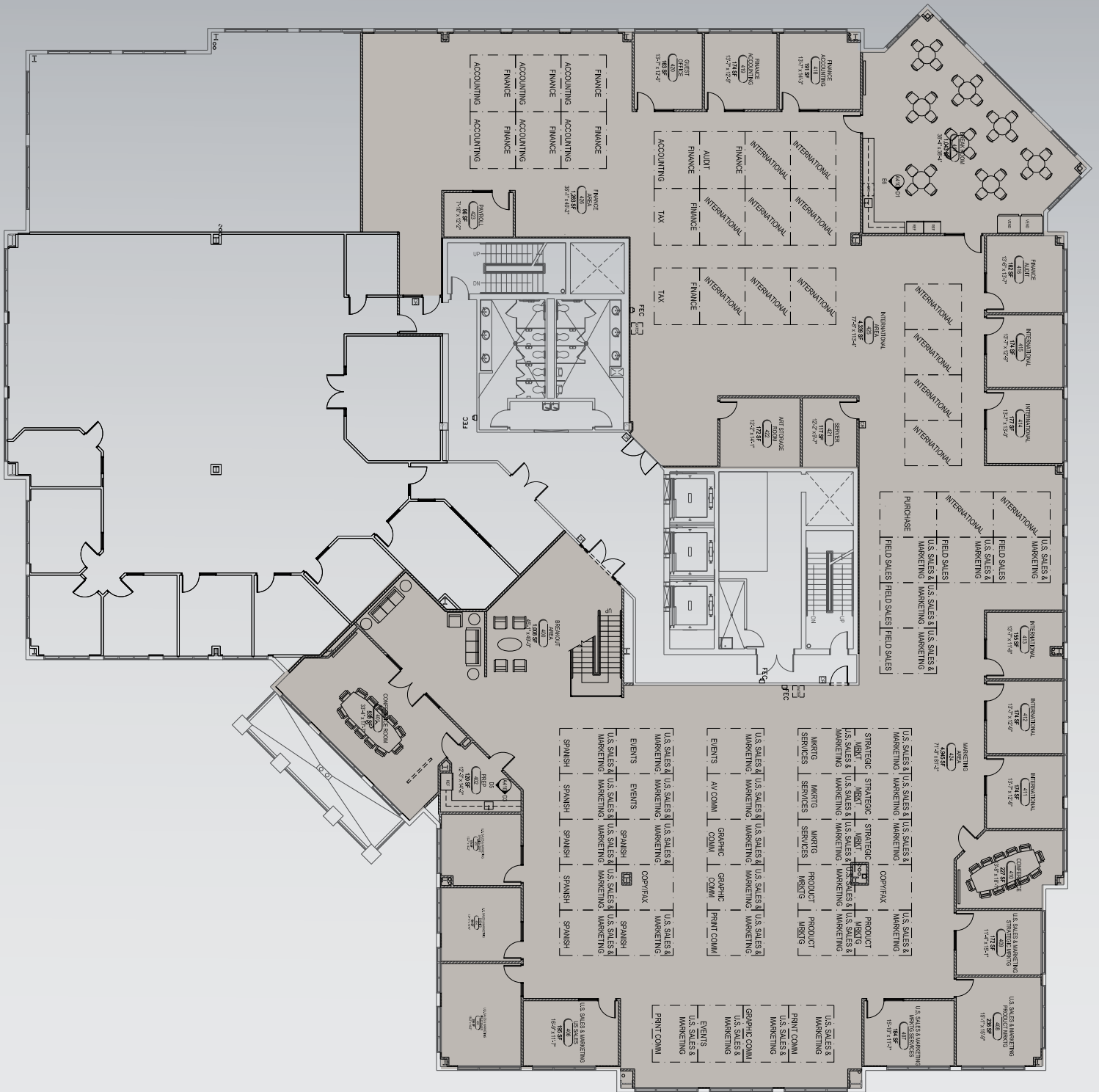

ADVISORS

John Petersen

801.209.8805

john.petersen@cbcadvisors.com

STACK

Andrew Bybee

801.768.0500

andrew@stackwithus.com

5TH FLOOR PLAN - 26,521 RSF



ADVISORS

John Petersen
 801.209.8805
 john.petersen@cbcadvisors.com



Andrew Bybee
 801.768.0500
 andrew@stackwithus.com

SURROUNDING AMENITIES MAP



ADVISORS

John Petersen
801.209.8805
john.petersen@cbcadvisors.com

STACK

Andrew Bybee
801.768.0500
andrew@stackwithus.com