



AEROHUB



Glendale Milford Rd at I-75
Evendale, OH 45215

CONTACTS

CBRE

John Eckert, Senior Vice President

+1 513 369 1321

john.eckert@cbre.com

CBRE

Travis Likes, First Vice President

+1 513 369 1364

travis.likes@cbre.com



CBRE



EVENDALE HIGHLIGHTS

- Home to 3 world headquarters (GE Aviation, Formica and Gold Medal Products)
- Immediate access to 3 major highways (I-75, I-275 and I-71)
- Award-winning recreation and cultural arts centers. Home of Gorman Heritage Farm
- “Business Ready” community with proven economic development strategies and incentives
- Strong partnerships with regional development facilitators including REDI and HCDC
- Excellent police, fire and public works services. Accessible staff and elected officials
- Low earnings tax
- Please visit: www.evendaleohio.org

LOCATION HIGHLIGHTS

- Located in the center of Southwest Ohio Aerospace Region (SOAR)
- 50,000 scientists and engineers within a 50 mile radius
- The I-75 Cincinnati/Dayton corridor is an aerospace powerhouse with more than 400 industry related support businesses
- Suppliers will have the advantage of being adjacent to GE Aviation and close proximity to potential customers, including Wright Patterson Air Force Base.
- Evendale is a main connection point for the Ohio Academic Resources Network (OAR net), the 100 Gbps network throughout Ohio.

STATE OF OHIO

- 400-plus aerospace industry related companies line the I-75 Cincinnati-Dayton corridor
- Home to Wright Patterson Air Force Base and GE Aviation
- A top 15 region in U.S. for aerospace products and parts manufacturing
- Southwest Ohio Aerospace Region (SOAR) was one of 12 regions awarded a federal "advance manufacturing" designation



SOUTHWEST OHIO AEROSPACE REGION (SOAR)

- \$10 billion annual investment in aerospace R&D
- 17% of total U.S. employment in aviation and aerospace located in Ohio
- #1 U.S. supplier to both Boeing and Airbus
- More than 1,200 private companies in the aerospace & defense industry
- Directly employs over 130,000 full-time aerospace and aviation employees
- Please visit <http://redicincinnati.com>

AEROHUB CAMPUS HIGHLIGHTS

- Planned 185+ acre advanced manufacturing ecosystem
 - Advanced manufacturing
 - Research and development
 - Aerospace
 - Engineering
- Adjacent to GE Aviation, world's leading provider of aircraft engines
- Over 523,000 Sq. Ft. of planned office and technology space
- Access to Advanced Manufacturing Workforce Skill Center
- Located near 3 major interstate systems (I-75, I-275, I-71)
- No property tax assessed by Evendale

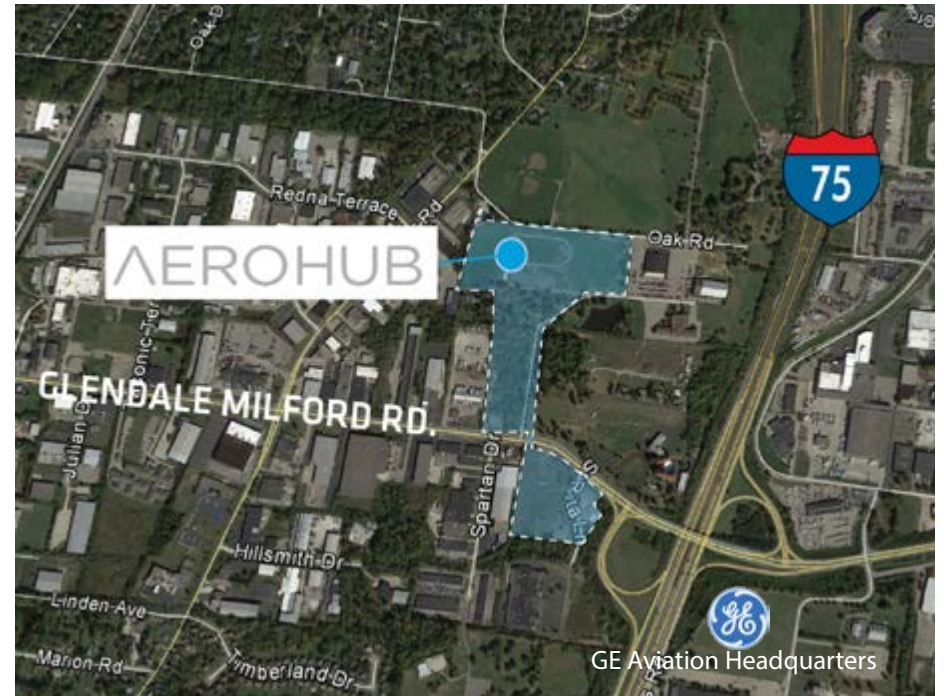
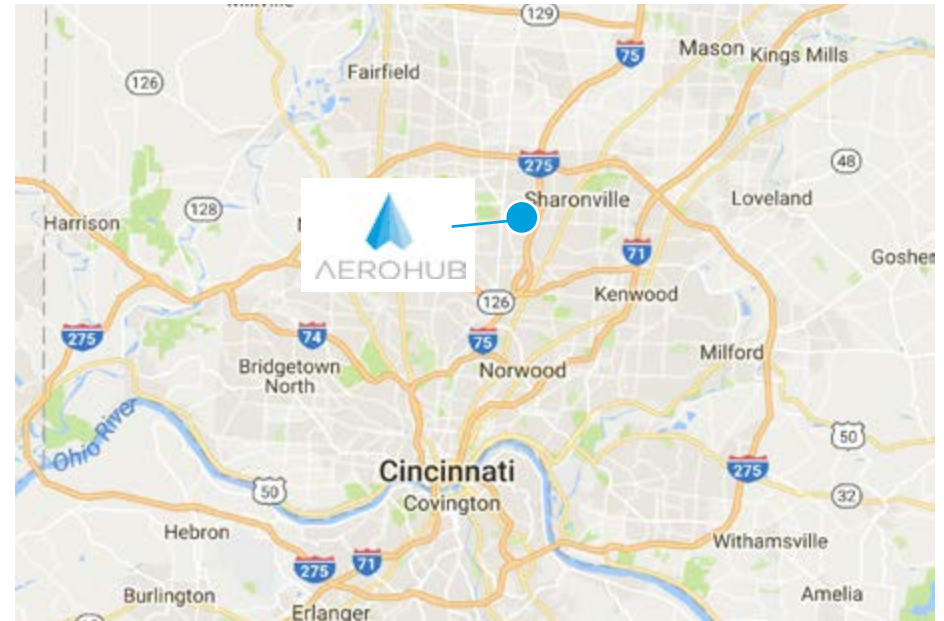

OFFICE BUILDING HIGHLIGHTS

- Three (3) story Class A office building
- Contemporary design
- 80,000 to 100,000 total sq. ft.
- Functional 26,000 to 33,000 sq. ft. floor plates
- 5+ parking spaces per 1,000 sq. ft.
- 9' ceiling height
- No property tax assessed by Evendale
- \$19.00 - \$21.00 per Sq. Ft. full service rental rate



FLOOR PLANS

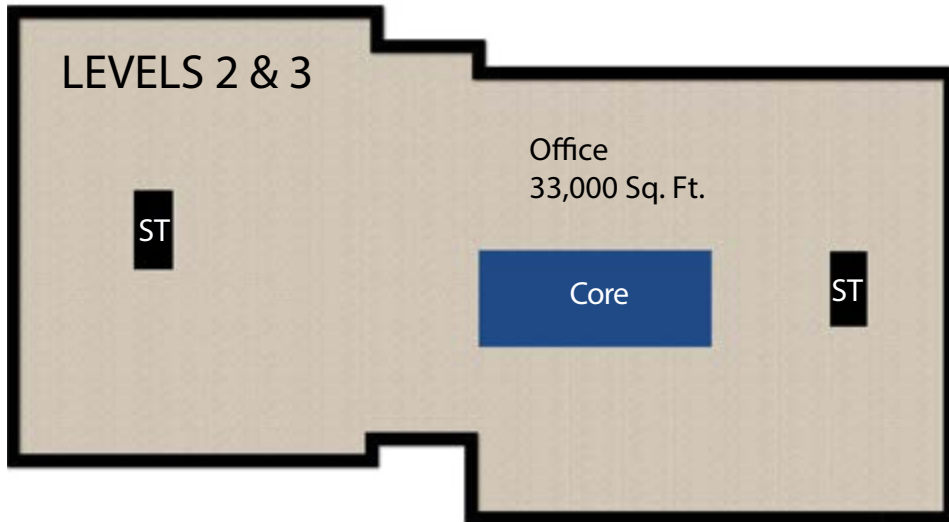
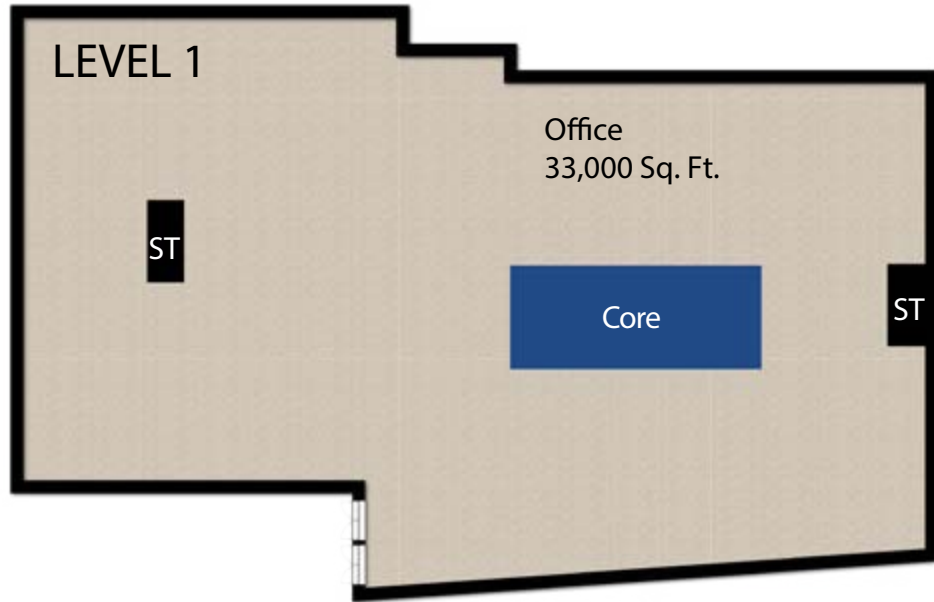

AEROHUB AMENITIES

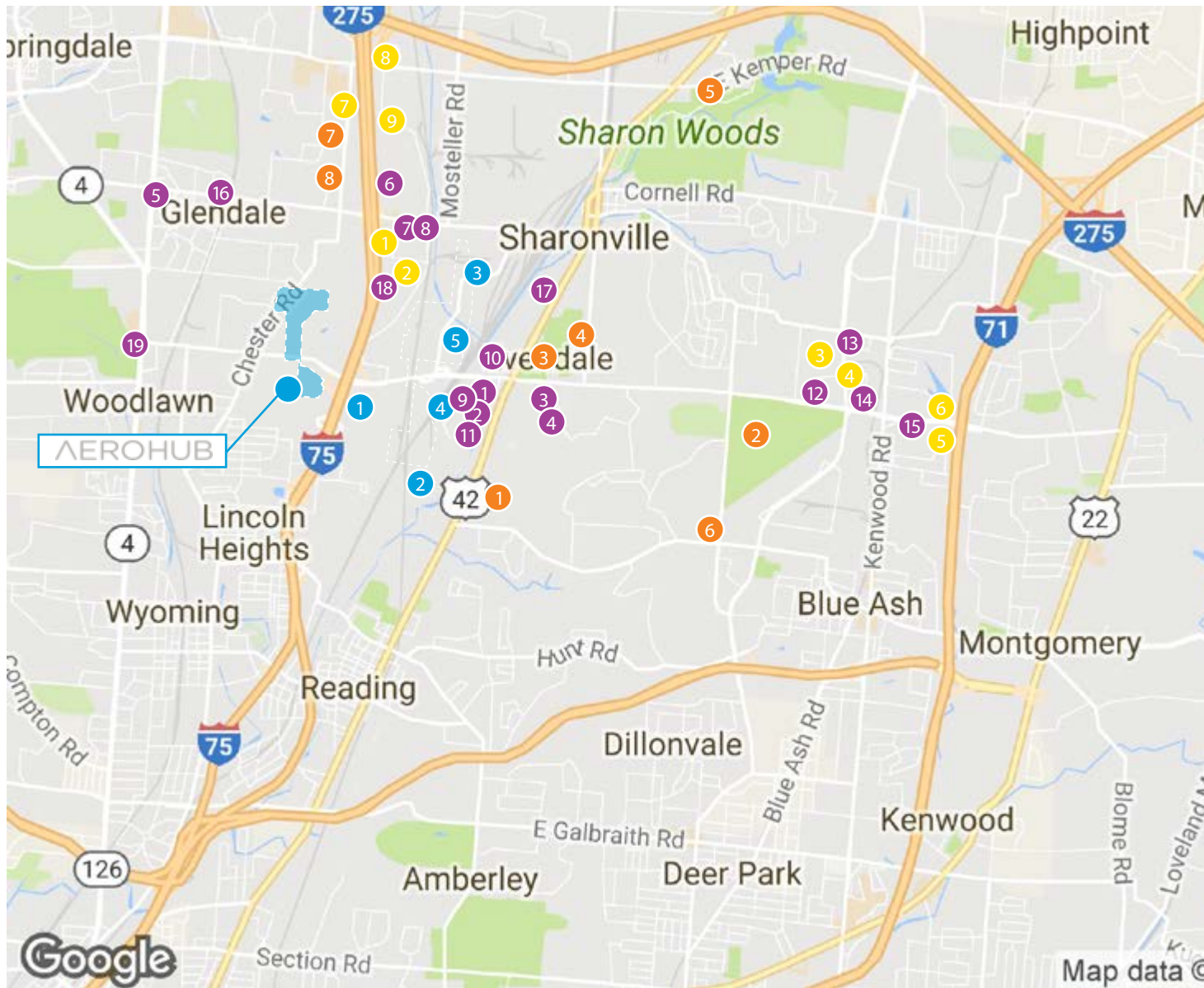

HEADQUARTERS

- 1 GE Aviation
- 2 Formica
- 3 Gold Medal Products
- 4 Kinetic Vision
- 5 KDM Pop Solutions

PARKS & RECREATION

- 1 Gorman Heritage Farm
- 2 Summit Park
- 3 Evendale Recreation Center
- 4 Griffin Family Nature Preserve
- 5 Sharon Woods
- 6 Blue Ash Golf Course
- 7 Sharonville Convention Center
- 8 Queen City Racquet Club

RESTAURANTS

- | | |
|-------------------|-----------------------|
| 1 Starbucks | 11 Starbucks |
| 2 Chipotle | 12 Buffalo Wild Wings |
| 3 LaPetite France | 13 Applebee's |
| 4 Sichuan Chili | 14 Firehouse Grill |
| 5 Grand Finale | 15 Bob Evans |
| 6 Bob Evans | 16 Cock & Bull |
| 7 Frisch's | 17 Wendy's |
| 8 Skyline | 18 Cracker Barrell |
| 9 Chipotle | 19 McDonald's |
| 10 Burger King | |

HOTELS

- | | |
|----------------------|-----------------|
| 1 Drury Inn | 6 Red Roof Inn |
| 2 Baymont | 7 Hyatt Place |
| 3 Embassy Suites | 8 Fairfield Inn |
| 4 Marriott Courtyard | 9 Ramada Plaza |
| 5 Crowne Plaza | |



CONTACT

CONTACTS

CBRE

John Eckert, Senior Vice President
 +1 513 369 1321 | john.eckert@cbre.com

CBRE

Travis Likes, First Vice President
 +1 513 369 1364 | travis.likes@cbre.com



AEROHUB



© 2017 CBRE, Inc. This information has been obtained from sources believed reliable. We have not verified it and make no guarantee, warranty or representation about it. Any projections, opinions, assumptions or estimates used are for example only and do not represent the current or future performance of the property. You and your advisors should conduct a careful, independent investigation of the property to determine to your satisfaction the suitability of the property for your needs. Photos herein are the property of their respective owners and use of these images without the express written consent of the owner is prohibited. CBRE and the CBRE logo are service marks of CBRE, Inc. and/or its affiliated or related companies in the United States and other countries. All other marks displayed on this document are the property of their respective owners.

CBRE