



change your view

200 South Wacker Drive **Chicago, IL**

200 South Wacker Drive offers superb views of the city and a unique central location on the banks of the Chicago River. Situated in the West Loop—part of Chicago's historic financial and commercial center—high-rise floors in the building offer unobstructed views of Lake Michigan, the Chicago River and the striking Chicago skyline.





200 South Wacker Drive
Chicago, IL



Building Overview

Discover the benefits of office space at 200 South Wacker.

- Beautiful Chicago skyline with waterfront views, and Wacker Drive riverfront location
- Easy access to commuter train stations (METRA), EL train stations, CTA bus stops and major expressways
- Water taxi to navy pier
- Close proximity to a number of cultural destinations, including Willis Tower and the Chicago Civic Opera House
- Numerous hotels, retail and restaurant options within walking distance

Property Highlights

Premium on-site amenities, including:

- Updated building conference center
- Upgraded fitness center
- Tenant wifi lounge and roof top deck overlooking the city and lake
- Renovated common area corridors
- Recently renovated building lobby and central security system



Questions? Contact:

Daniel Shapiro

Leasing Director T: 312.551.0188 E: Daniel_Shapiro@jhancock.com

Christine Choi Moore

Leasing Manager T: 312.551.0141 E: Christine_Moore@jhancock.com





200 South Wacker Drive Chicago, IL



A Superior Location

200 South Wacker offers superior access to public transportation including Metra and convenient access to the "L" train lines.

- CTA bus stop at entrance and 5-minute walk to EL Train Stations
- Convenient access to Union Station



Questions? Contact:

Daniel Shapiro

Leasing Director T: 312.551.0188 E: Daniel_Shapiro@jhancock.com

Christine Choi Moore

Leasing Manager T: 312.551.0141 E: Christine_Moore@jhancock.com





200 South Wacker Drive
Chicago, IL



Stacking Plan and Availability

Suite	SF	Net Rent
4000	11,488	\$27.00

3000	8,248	\$24.00
2200	22,675	\$24.00
1850	4,785	\$24.00
1550	5,416	\$22.00
1050	4,437	\$22.00
975	4,600	\$22.00
820	10,705	\$22.00

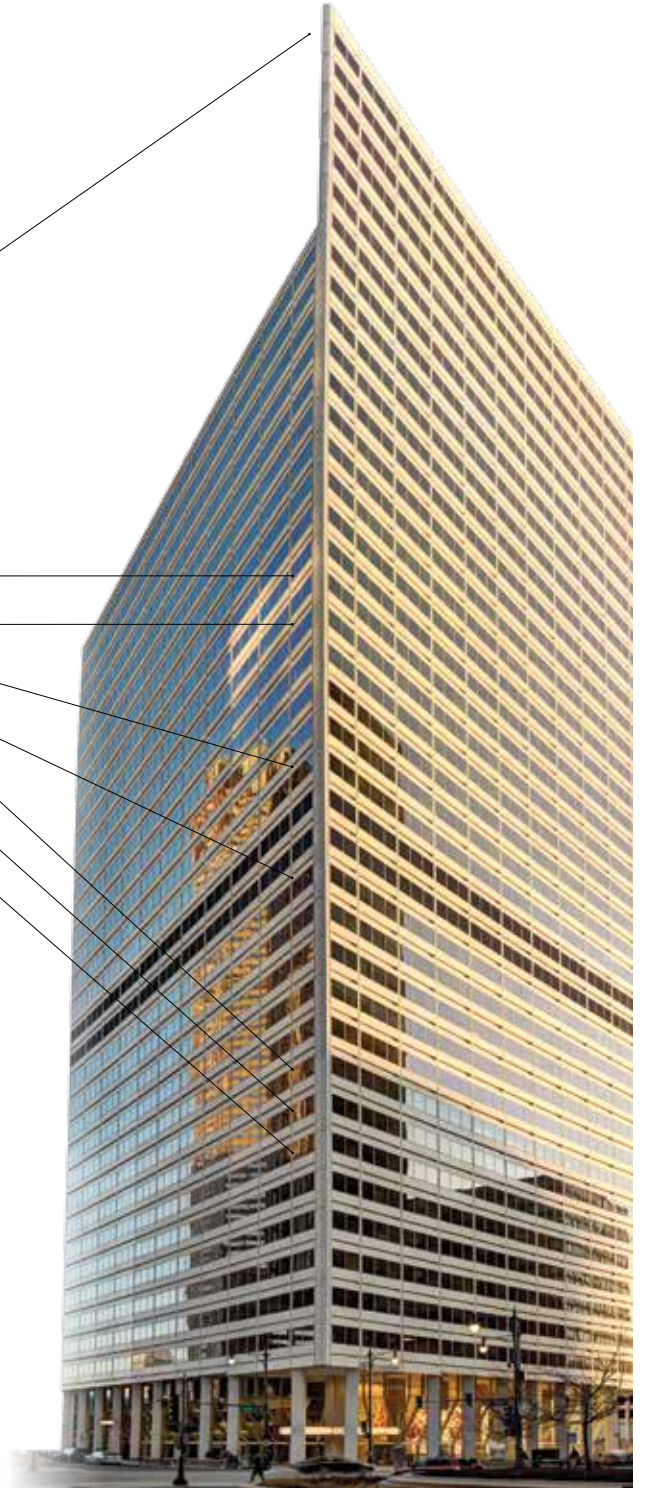

Questions? Contact:

Daniel Shapiro

Christine Choi Moore

Leasing Director T: 312.551.0188 E: Daniel_Shapiro@jhancock.com

Leasing Manager T: 312.551.0141 E: Christine_Moore@jhancock.com



Real Estate



200 South Wacker Drive
Chicago, IL



Existing Law Firm Conditions

Suite 3000 • 8,248 SF



- Private Office - 14
- Meeting Areas - 2
- Workstations - 6
- Common Areas - 2

Questions? Contact:

Daniel Shapiro
Christine Choi Moore

Leasing Director T: 312.551.0188 E: Daniel_Shapiro@jhancock.com
Leasing Manager T: 312.551.0141 E: Christine_Moore@jhancock.com



change
your
view

200 South Wacker Drive
Chicago, IL



Modern Open Test Fit

Suite 2200 • 22,675 SF

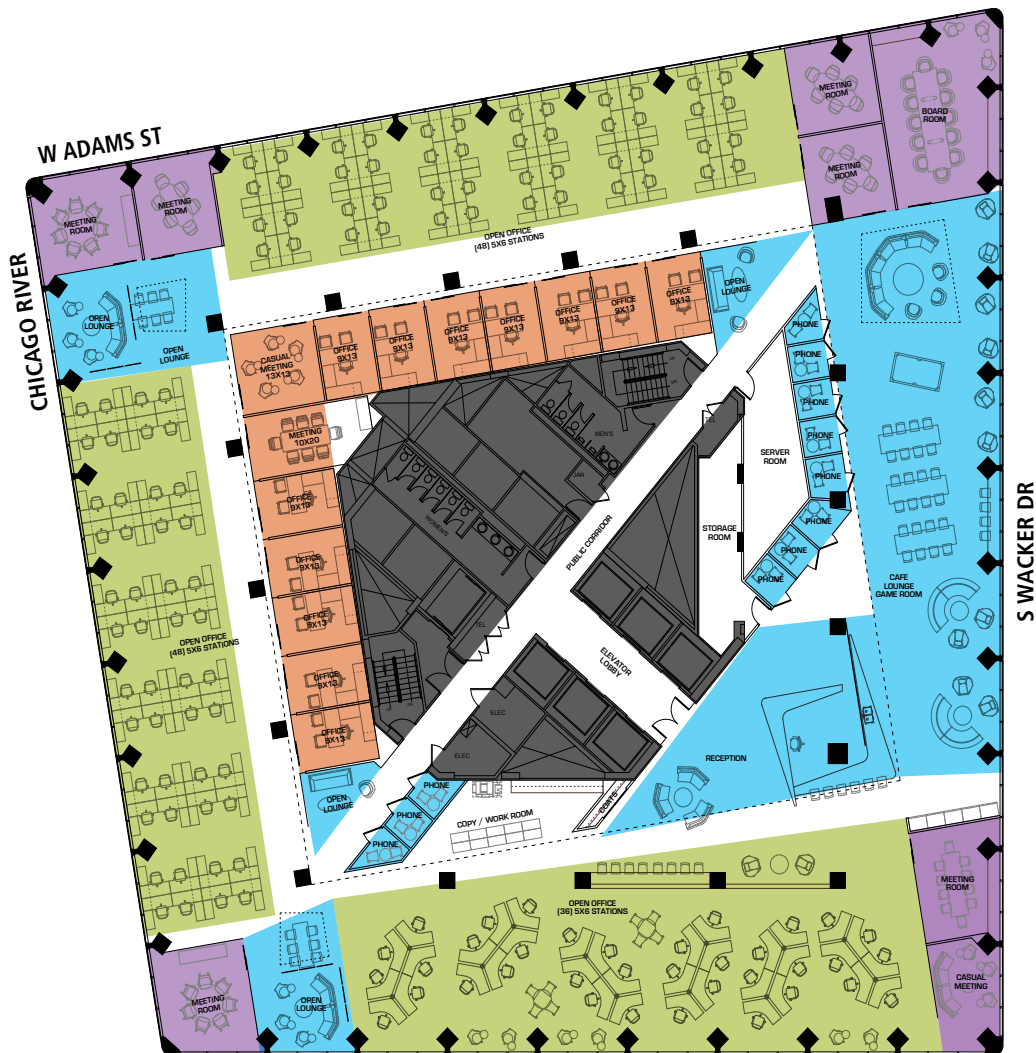

Private Office - 13
 Meeting Areas - 10
 Workstations - 132
 Common Areas - 18

Questions? Contact:

Daniel Shapiro
Christine Choi Moore

Leasing Director T: 312.551.0188 E: Daniel_Shapiro@jhancock.com
Leasing Manager T: 312.551.0141 E: Christine_Moore@jhancock.com





200 South Wacker Drive
Chicago, IL



Proposed Office Test Fit

Suite 1850 • 4,785 SF

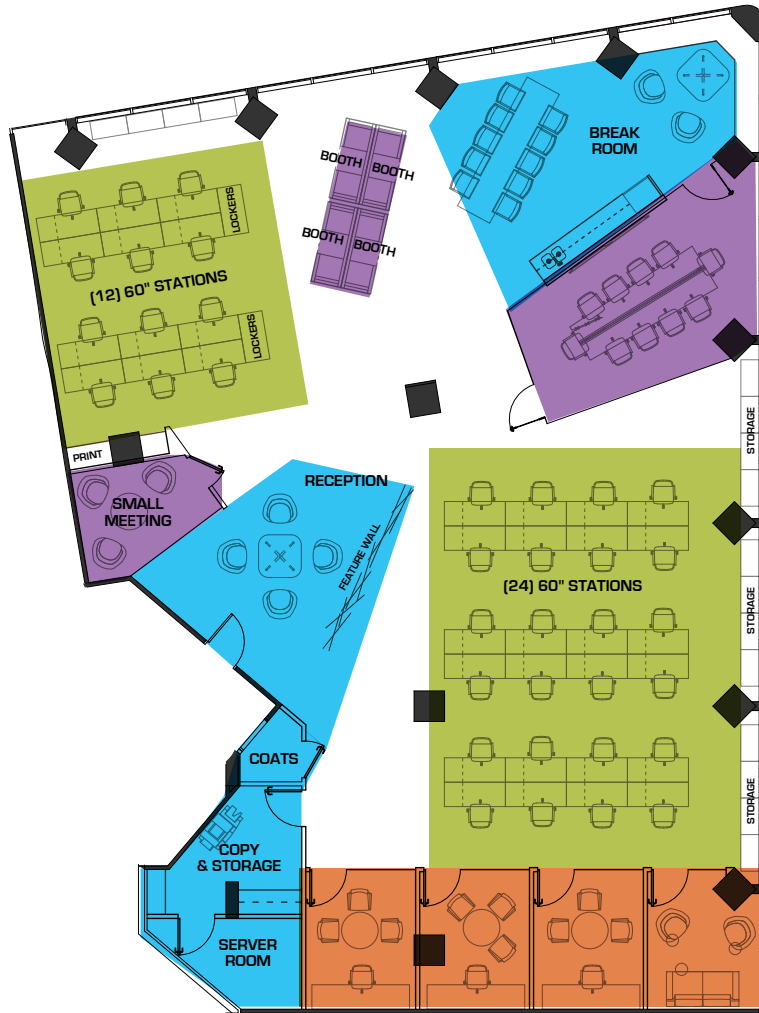

- Private Office - 4
- Meeting/Call Rooms - 6
- Workstations - 36
- Breakroom/Reception/Copy

Questions? Contact:

Daniel Shapiro

Leasing Director T: 312.551.0188 E: Daniel_Shapiro@jhancock.com

Christine Choi Moore

Leasing Manager T: 312.551.0141 E: Christine_Moore@jhancock.com



Real Estate

change
your
view

200 South Wacker Drive
Chicago, IL



Gallery

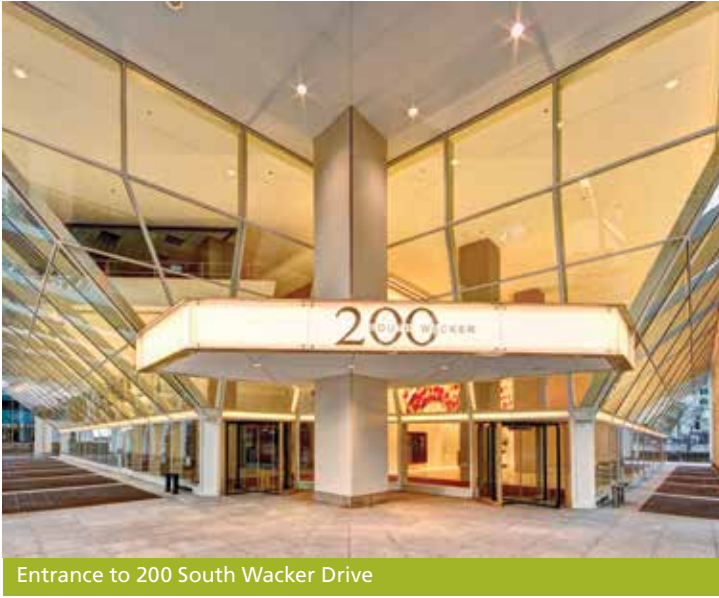

Entrance to 200 South Wacker Drive



Conference Center



Lobby



Rooftop Tenant Lounge



Fitness Facility

Questions? Contact:

Daniel Shapiro

Leasing Director T: 312.551.0188

E: Daniel_Shapiro@jhancock.com

Christine Choi Moore

Leasing Manager T: 312.551.0141

E: Christine_Moore@jhancock.com

John Hancock

Real Estate