

## 1111 GRECADE ST

*Greensboro, NC 27408*

### PROPERTY HIGHLIGHTS

- 2,000 SF space located in Midtown Greensboro
- Visibility on Battleground Avenue (40,000 ADT)
- Located in the heart of the Restaurant District
- Retailers nearby include RED Cinemas, Burger Warfare, Pig Pounder Brewery, Max's Speed Shop, Trek Bicycles, Sheetz, BB&T & more.
- LAT: 36.084535 LONG: -79.80452

**KOTIS**  
336.574.2000 | [kotis.org](http://kotis.org)





# 1111 GRECADE ST

Greensboro, NC 27408



**ADDITIONAL  
PHOTOS**

**MARTY KOTIS**

336.574.2000

[marty@kotisprop.com](mailto:marty@kotisprop.com)



# 1111 GRECADE ST

Greensboro, NC 27408

LEASE TYPE | NNN

TOTAL SPACE | 2,000 SF

LEASE TERM | Negotiable

CAM & TAX | Negotiable

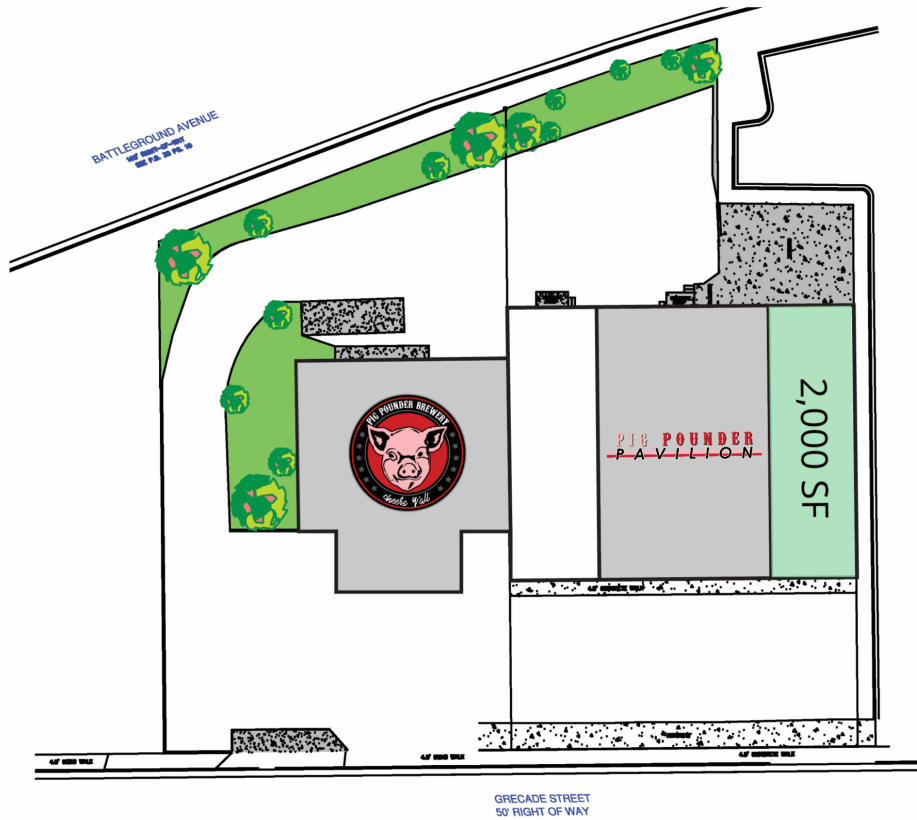

UNAVAILABLE

AVAILABLE

SUITE	TENANT	SIZE	TYPE	RATE
1111 GreCADE St	Available	2,000 SF	NNN	Negotiable



KOTIS

AVAILABLE  
SPACES

MARTY KOTIS

336.574.2000

marty@kotisprop.com





# 1111 GRECADE ST

Greensboro, NC 27408



Map data ©2018 Google Imagery ©2018, DigitalGlobe, U.S. Geological Survey, USDA Farm Service Agency



KOTIS

## RETAILER MAP

MARTY KOTIS

336.574.2000

marty@kotisprop.com





# 1111 GRECADE ST

Greensboro, NC 27408

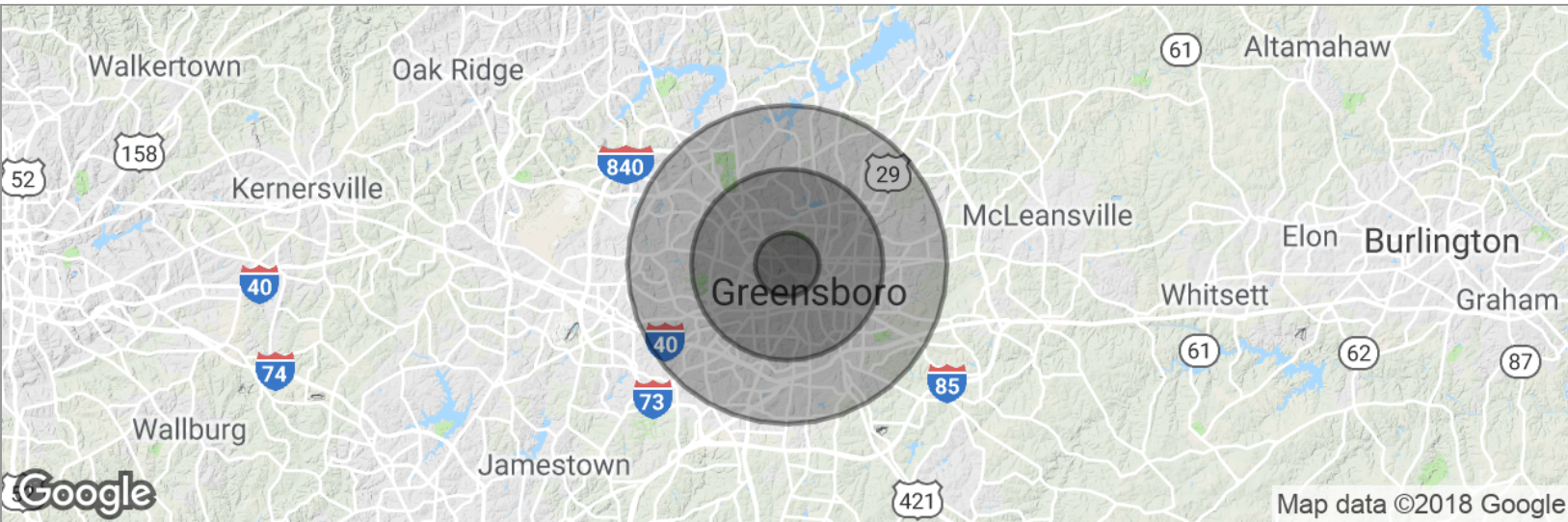

## POPULATION

	1 MILE	3 MILES	5 MILES
Total population	9,300	86,359	203,792
Median age	36.2	33.9	35.0
Median age (Male)	36.1	32.8	33.6
Median age (Female)	36.5	35.0	36.5

## HOUSEHOLDS & INCOME

	1 MILE	3 MILES	5 MILES
Total households	3,911	33,993	82,337
# of persons per HH	2.4	2.5	2.5
Average HH income	\$84,267	\$61,525	\$58,638
Average house value	\$380,854	\$240,662	\$199,735

\* Demographic data derived from 2010 US Census

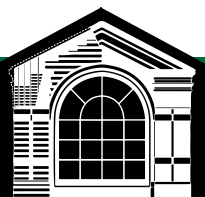

KOTIS

DEMOGRAPHICS  
MAP

MARTY KOTIS  
336.574.2000  
marty@kotisprop.com

