

**TOTAL SF AVAILABLE:**  
**5,400 SF**

**KEY PLAN**  
NOT TO SCALE

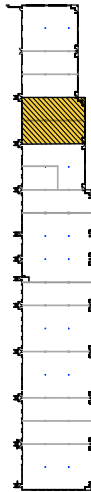

NOTE: THIS SPACE PLAN IS  
SUBJECT TO EXISTING FIELD  
CONDITIONS. THIS DRAWING  
IS PROPRIETARY AND THE  
EXCLUSIVE PROPERTY OF ST.  
JOHN PROPERTIES, INC. ANY  
DUPLICATIONS, DISTRIBUTION,  
OR OTHER UNAUTHORIZED USE  
IS STRICTLY PROHIBITED.



### About Reisterstown Business Center

This 16-acre mixed-use business community is located off MD Route 140 in Reisterstown, Maryland in Baltimore County.

The unified architecture of St. John Properties' three buildings, comprising approximately 118,000 square feet of office space and R&D/flex, provide Reisterstown Business Center a campus-like business environment. Tenant sizes from 1,950 square feet to 59,400 square feet of space offer businesses straight-forward, economical and high-utility space in a covenant-protected, well-maintained atmosphere. Thirty foot wide spaces combined with 16 foot high ceiling heights offer maximum flexibility. Free, generous parking is available adjacent to the building.

St. John Properties features an in-house and fully-staffed property management division, to ensure that each building continually operates at peak performances.

DEMOGRAPHICS			
	1 Mile	3 Miles	5 Miles
Population	9,165	43,809	80,244
Avg. Household Income	\$78,474	\$92,719	\$96,273



### FLEX / R&D SPACE

SINGLE-STORY FLEX / R&D BUILDINGS	
100-132 Business Center Drive	47,400 SF
200-240 Business Center Drive	59,400 SF
300-322 Business Center Drive	25,800 SF
FLEX / R&D SPECIFICATIONS	
Suite Sizes	1,950 – 3,000 SF
Ceiling Height	16 ft. clear minimum
Offices	Built to suit
Parking	4 spaces per 1,000 SF
Heat	Gas
Roof	EPDM rubber
Exterior Walls	Brick on block
Loading	Dock or drive-in
Zoning	BR



### RETAIL PAD SITE

RETAIL PAD SITE	
Available Pad Site	.61 Acres   Zoned BL







### Distances to:

Baltimore (Downtown).....	17 miles
BWI Airport.....	25 miles
Columbia, MD.....	21 miles
I-95.....	19 miles
I-795.....	3 miles
I-695 (Baltimore Beltway).....	9 miles
Owings Mills, MD.....	5 miles
Towson, MD.....	15 miles
Westminster, MD.....	12 miles



2560 Lord Baltimore Drive  
Baltimore, MD 21244

410.788.0100 | SJPI.COM

CO | MD | NV | PA | LA | UT | VA | WI

### About St. John Properties

St. John Properties, Inc. is a full-service real estate company headquartered in Baltimore, Maryland. The company owns, manages and has developed more than 18 million square feet of commercial real estate, including flex/R&D, warehouse, office and retail space.

**For additional leasing information or  
to schedule a tour, contact:**

**Will McCullough** *Leasing Agent*  
410.369.1207 | [wmccullough@sjpi.com](mailto:wmccullough@sjpi.com)

**Richard Williamson**  
*SVP Leasing & Marketing*  
410.369.1222 | [rwilliamson@sjpi.com](mailto:rwilliamson@sjpi.com)



Follow us on social media @stjohnprop  

This information contained in this publication has been obtained from sources believed to be reliable. St. John Properties makes no guarantee, warranty or representation about this information. Any projections, opinions, assumptions or estimates used here are for example only and do not represent the current or future performance of the property. Interested parties should conduct an independent investigation to determine whether the property suits their needs. REV 06/17