

25800-25840 SHERWOOD
UNIT #25800
WARREN, MICHIGAN

OFFICE/HI-TECH FOR LEASE
2,000-22,160 Square Feet Available



**SIGNATURE
ASSOCIATES**
KNOW SIGNATURE | KNOW RESULTS



PROPERTY FEATURES

- 2,000-22,160 square feet available
- Office space available within a manufacturing facility
- 133,332 square foot building situated on 8.95 acres
- Up to 11' clear height
- Zoned M-3
- Heavy parking
- Seconds from I-696 and the Mound Road corridor
- Lease Rate: \$4.50/sf NNN

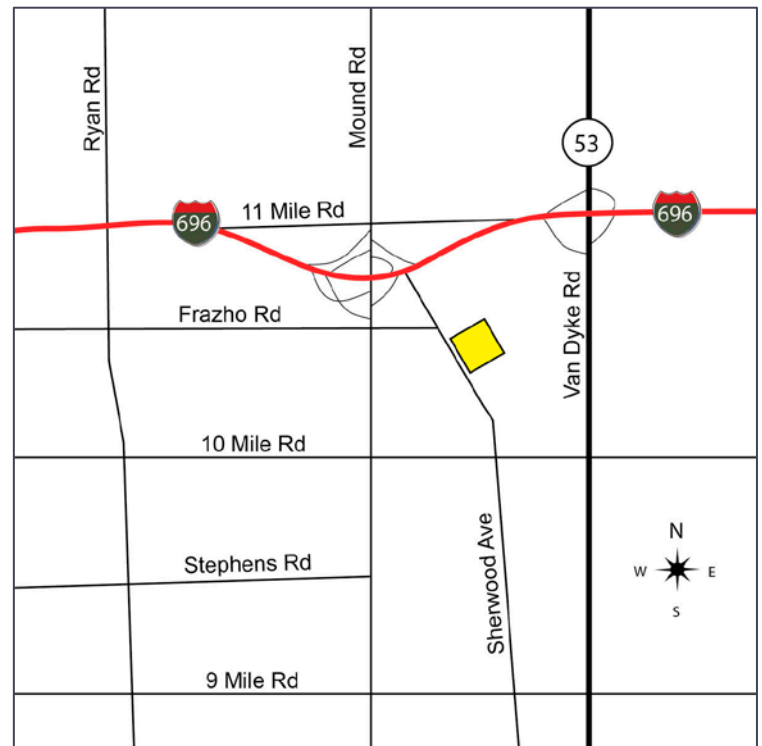

For more information, please contact:

BEN WILKIEMEYER
(248) 359 0624
bwilkiemeyer@signatureassociates.com

PAUL SAAD
(248) 359 0652
psaad@signatureassociates.com

SIGNATURE ASSOCIATES
One Towne Square, Suite 1200
Southfield, MI 48076
www.signatureassociates.com

25800-25840 Sherwood Ave. Unit #25800 - Warren, MI

Office/Hi-Tech For Lease

2,000 – 22,160
Square Feet
AVAILABLE

Site Plan

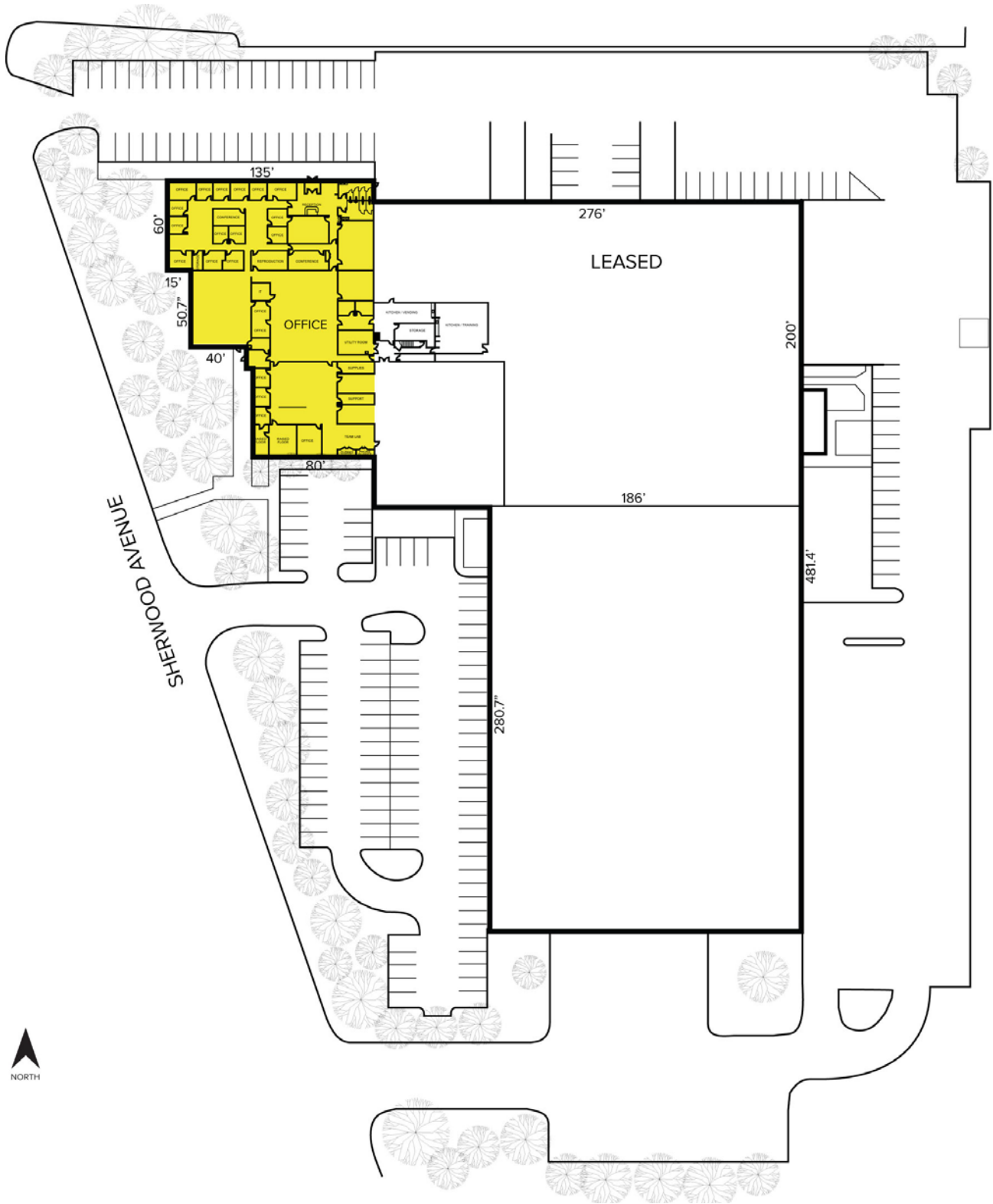

For more information, please contact:

BEN WILKIEMEYER
(248) 359 0624
bwilkiemeyer@signatureassociates.com

PAUL SAAD
(248) 359 0652
psaad@signatureassociates.com

SIGNATURE ASSOCIATES
One Towne Square, Suite 1200
Southfield, MI 48076
www.signatureassociates.com

Floor Plan

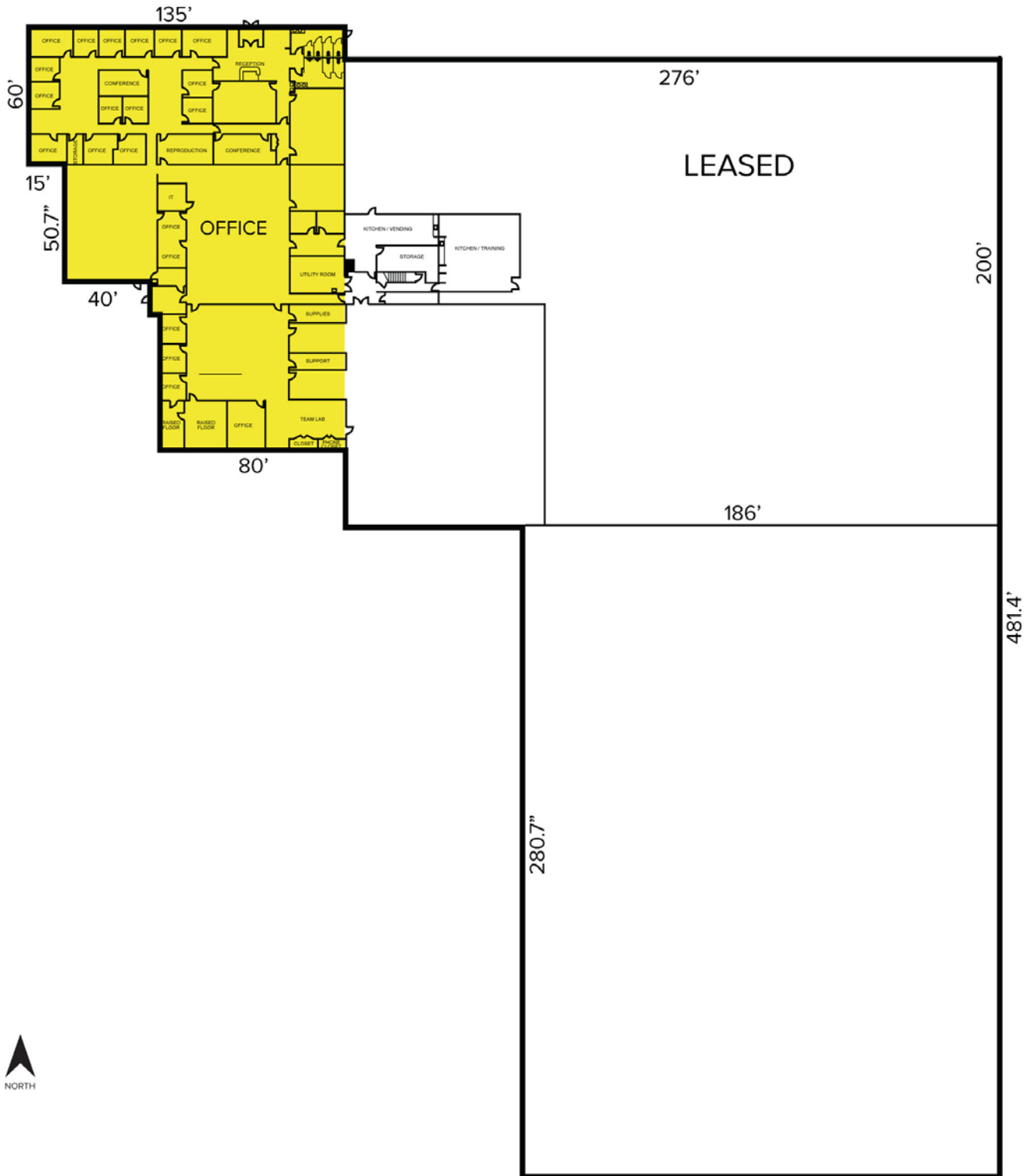

For more information, please contact:

BEN WILKIEMEYER
(248) 359 0624
bwilkiemeyer@signatureassociates.com

PAUL SAAD
(248) 359 0652
psaad@signatureassociates.com

SIGNATURE ASSOCIATES
One Towne Square, Suite 1200
Southfield, MI 48076
www.signatureassociates.com