



Park 2000 Phase II – 5555 12<sup>th</sup> Ave East

---

SHAKOPEE, MINNESOTA

## BUILDING DETAILS

- Total Building Size: 128,872 SF
  - ◆ Total Available SF: 26,934 SF
  - ◆ Office SF: 3,200 SF
- Rental Rate
  - ◆ Warehouse: \$5.00/SF
  - ◆ Office: \$10.00/SF
- 2018 Estimated Operating Expenses
  - ◆ CAM: \$1.04/SF (includes mgmt fee)
  - ◆ Tax: \$1.89/SF
  - ◆ Total: \$2.95/SF
- Clear Height: 24'
- Column Spacing: 40' x 36'
- Power: 400 amps, 480/277 volts
- Dock Doors: 3 (ability to add more)
- Car Parking: 67 spaces



Adam Bray | 952.833.5251 | [abray@libertyproperty.com](mailto:abray@libertyproperty.com)  
Dan Larew | 612.217.6726 | [dan.larew@am.jll.com](mailto:dan.larew@am.jll.com)

Chris Hickok | 612.217.5121 | [chris.hickok@am.jll.com](mailto:chris.hickok@am.jll.com)



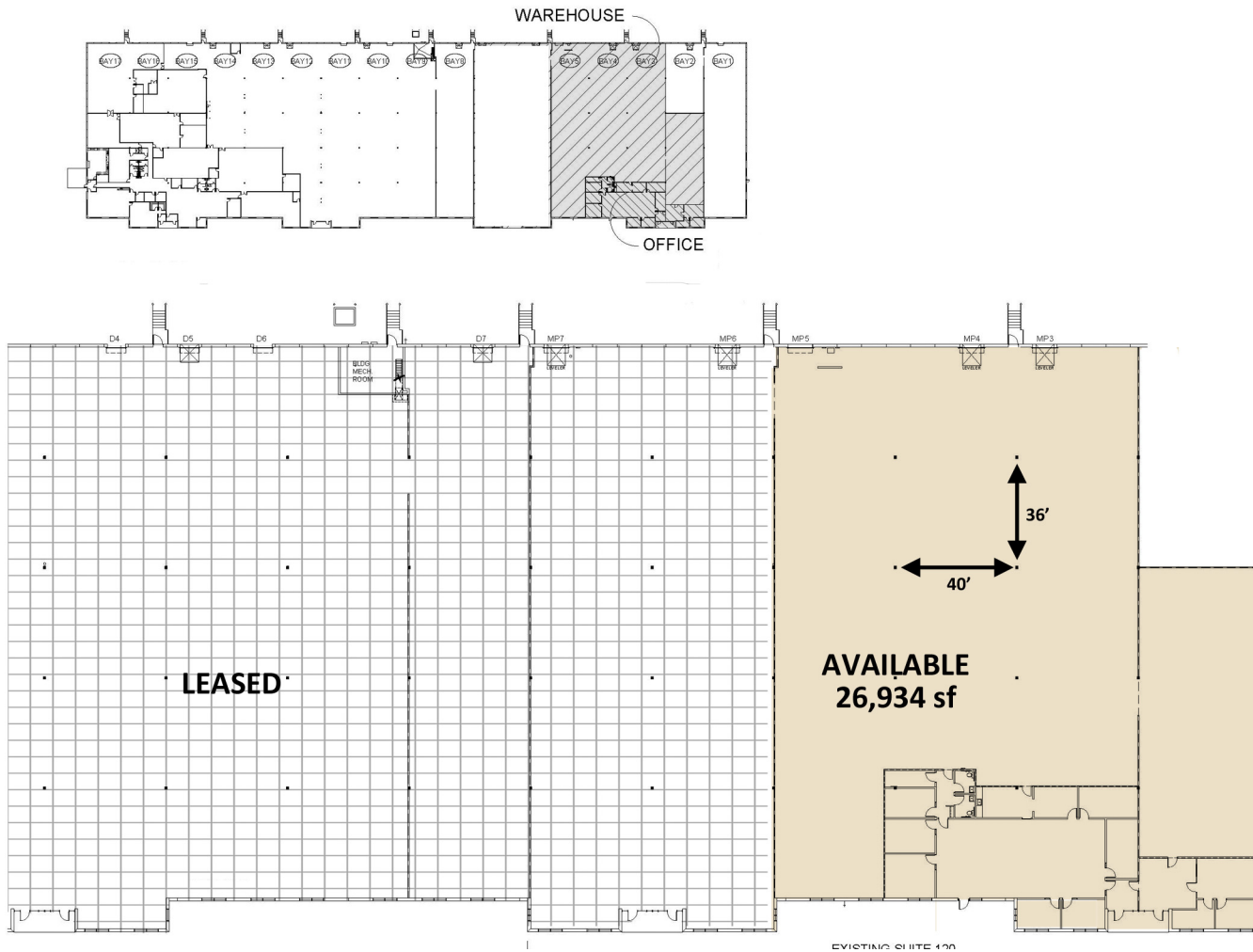

Adam Bray | 952.833.5251 | abray@libertyproperty.com  
Dan Larew | 612.217.6726 | dan.larew@am.jll.com

Chris Hickok | 612.217.5121 | chris.hickok@am.jll.com





Adam Bray | 952.833.5251 | abray@libertyproperty.com  
Dan Larew | 612.217.6726 | dan.larew@am.jll.com

Chris Hickok | 612.217.5121 | chris.hickok@am.jll.com

