

FOR LEASE

CENTENNIAL PLAZA

35400 VINE STREET, EASTLAKE, OH 44095

RETAIL



PROPERTY INFO

- + Join Two Bucks Bar & Grill, Master Pizza, Chase Bank, Boost Mobile & more on busy Vine Street shopping center
- + Available spaces:
Suite 3: 1,225 SF
Suite 5 - 7: 3,261 SF
- + Former restaurant with hood system and kitchen equipment in place
- + Traffic Counts:
Vine Street: 15,521 VPD
SOM: 18,843 VPD
(Source: ODOT TIMS)
- + Pylon signage available
- + Recently remodeled facade
- + Positioned directly behind Cleveland Indians Single A Affiliate Lake County Captains baseball stadium
- + Close proximity to Walmart, Target, BJ's Wholesale, Lowes, Giant Eagle, Regal Cinemas, and more!
- + Dense population of 60,223 people in a 3 mile radius
- + Average Household Income of \$60,478 in a 3 mile radius

FOR LEASE

CENTENNIAL PLAZA

35400 VINE STREET, EASTLAKE, OH 44095

RETAIL

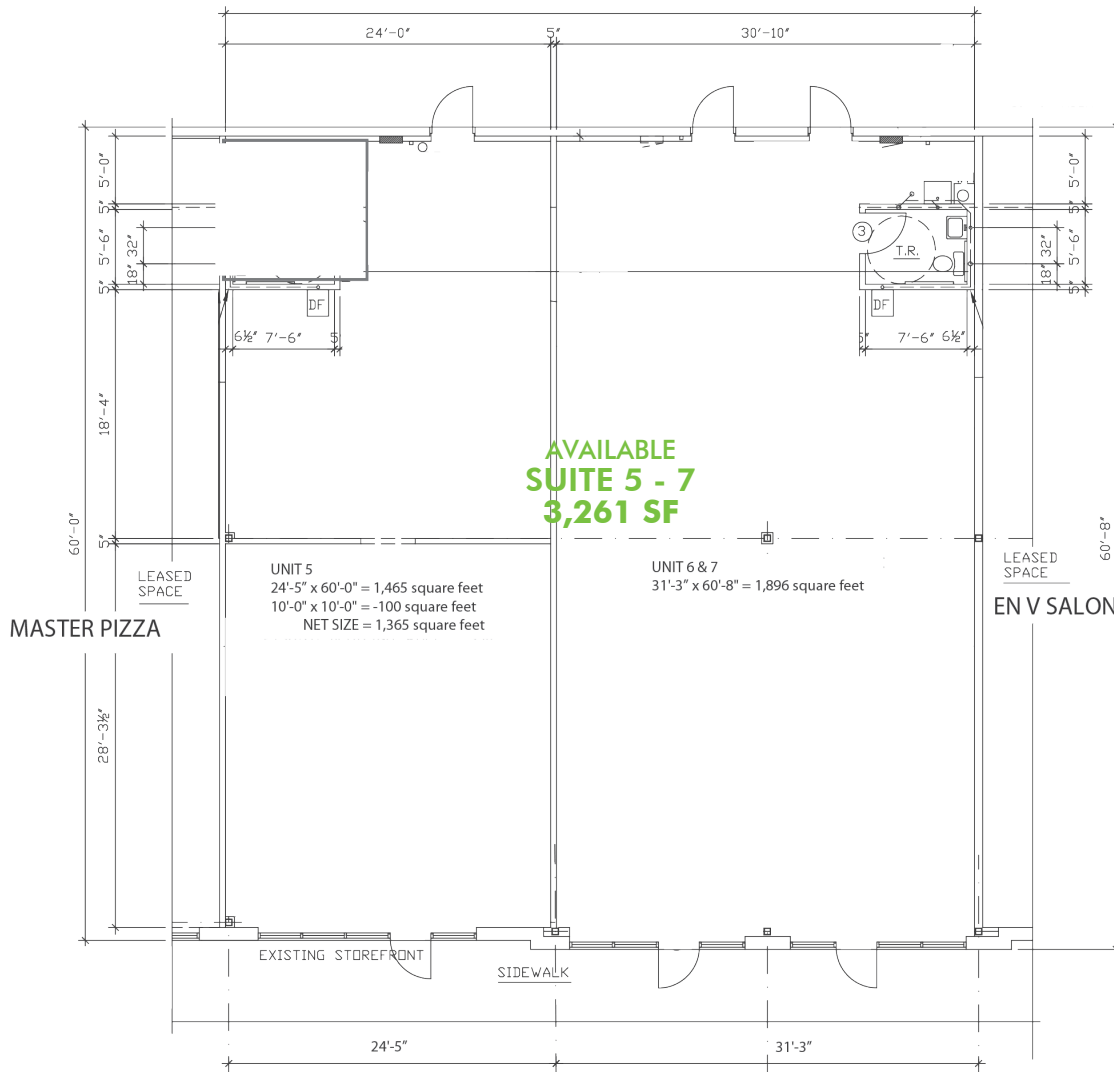

PROPERTY AVAILABILITY

SUITES	RSF
Suite 3	1,225 SF
Suite 5	1,365 SF
Suite 6 - 7	1,896 SF
Suite 5 - 7	3,261 SF

CONTACT US

Kevin Moss

Senior Associate
+1 216 363 6453
kevin.moss@cbre.com

CBRE, Inc.

950 Main Avenue, Suite 200
Cleveland, OH 44113
+1 216 687 1800

www.cbre.com/cleveland

CBRE

FOR LEASE

CENTENNIAL PLAZA

35400 VINE STREET, EASTLAKE, OH 44095

RETAIL



FOR LEASE

CENTENNIAL PLAZA

35400 VINE STREET, EASTLAKE, OH 44095

RETAIL



FOR LEASE

CENTENNIAL PLAZA

35400 VINE STREET, EASTLAKE, OH 44095

RETAIL



DEMOGRAPHIC BRIEF

35400 VINE ST

	1 Mile	3 Miles	5 Miles
POPULATION			
2015 Population	7,444	60,223	114,695
2020 Population	7,235	60,185	114,519
2010 Population	7,722	60,409	115,291
2000 Population	10,063	62,256	120,188
Percent Pop Change: 2010 to 2015	-3.6%	-0.3%	-0.5%
Percent Pop Change: 2015 to 2020	-2.8%	-0.1%	-0.2%
AGE			
2015 Median Age	43.4	44.3	43.4
2015 Average Age	42.2	43.3	42.5
HOUSEHOLDS			
2015 Households	3,263	27,201	51,803
2020 Households	3,215	27,487	52,300
2010 Households	3,312	26,817	51,198
2000 Households	4,368	26,595	51,823
Percent HH Change: 2010 to 2015	-1.5%	1.4%	1.2%
Percent HH Change: 2015 to 2020	-1.5%	1.1%	1.0%
Average Household Size	2.3	2.2	2.2
INCOME			
2015 Median Household Income	\$48,691	\$49,764	\$48,605
2015 Average Household Income	\$57,207	\$60,478	\$60,193
2015 Per Capita Income	\$25,073	\$27,316	\$27,187
HOUSING UNITS			
2015 Housing Units	3,529	29,291	56,850
2015 Occupied Housing Units	3,263	27,201	51,803
2015 Vacant Housing Units	267	2,091	5,047
2015 Owner-Occupied Housing Units	2,294	19,141	34,083
2015 Renter-Occupied Housing Units	968	8,060	17,720
EDUCATION			
2015 Population Age 25 and Over	5,457	44,234	83,008
High School thru Associates	3,817 69.9%	29,957 67.7%	55,978 67.4%
Bachelor's Degree	606 11.1%	6,709 15.2%	13,189 15.9%
Graduate Degree	302 5.5%	3,408 7.7%	6,553 7.9%
PLACE OF WORK			
Total Businesses	739	3,195	5,721

CONTACT US

Kevin Moss

Senior Associate
+1 216 363 6453
kevin.moss@cbre.com

CBRE, Inc.

950 Main Avenue, Suite 200
Cleveland, OH 44113
+1 216 687 1800

© 2018 CBRE, Inc. This information has been obtained from sources believed reliable. We have not verified it and make no guarantee, warranty or representation about it. Any projections, opinions, assumptions or estimates used are for example only and do not represent the current or future performance of the property. You and your advisors should conduct a careful, independent investigation of the property to determine to your satisfaction the suitability of the property for your needs. Photos herein are the property of their respective owners and use of these images without the express written consent of the owner is prohibited. CBRE and the CBRE logo are service marks of CBRE, Inc. and/or its affiliated or related companies in the United States and other countries. All other marks displayed on this document are the property of their respective owners.

www.cbre.com/cleveland

